



FITTING INSTRUCTIONS FOR AB0065 ADVENTURE BARS



THIS KIT CONTAINS THE ITEMS PICTURED AND LABELLED OVER PAGE.

SOME PARTS MAY BE SHOWN FOR CLARITY OF INSTRUCTIONS ONLY.

DO NOT PROCEED UNTIL YOU ARE SURE ALL PARTS ARE PRESENT.

PLEASE READ ALL INSTRUCTIONS BEFORE PROCEEDING.

**IF IN ANY DOUBT WHEN FITTING OUR PRODUCTS, CONSULT ONE OF OUR DEALERS OR
HAVE FITTED BY A QUALIFIED TECHNICIAN.**

PLEASE NOTE THAT THE WAY THE KIT IS PACKED DOES NOT NECESSARILY REPRESENT THE WAY OF
MOUNTING TO THE BIKE.

IN THE EVENT OF RUBBER WASHERS BEING USED TO HOLD COMPONENTS ONTO BOLTS,
THESE RUBBER WASHERS CAN BE THROWN AWAY.

DIGITAL COPIES OF THESE INSTRUCTIONS ARE AVAILABLE TO DOWNLOAD FROM

WWW.RG-RACING.COM

R&G

Unit 1, Shelley's Lane, East Worldham, Alton, Hampshire, GU34 3AQ

Tel: +44 (0)1420 89007 Fax: +44 (0)1420 87301 www.rg-racing.com Email: info@rg-racing.com



<u>TOOLS REQUIRED</u>	<u>GENERAL TORQUE SETTINGS</u>
<ul style="list-style-type: none"> • TORX BIT SET & WRENCH • 10MM SPANNER • METRIC ALLEN KEY SET • TORQUE WRENCH • SUITABLE JACK WITH SOFT SUPPORT AREA (TO SUPPORT ENGINE WHILE MOUNTING BOLTS REMOVED). 	<p>M4 BOLT = 8Nm</p> <p>M5 BOLT = 12Nm</p> <p>M6 BOLT = 15Nm</p> <p>M8 BOLT = 20Nm</p> <p>M10 BOLT = 40Nm</p> <p>M12 BOLT = 40Nm</p>

LEGEND

ITEM NO.	DESCRIPTION	QTY
ITEM 1	LHS CRASH BAR ASSEMBLY (AB0065 LHS ASSY)	1
ITEM 2	RHS CRASH BAR ASSEMBLY (AB0065 RHS ASSY)	1
ITEM 3	M12 x 130mm BOLT (LHS FRONT)	1
ITEM 4	LHS TOP SPACER 21mm (S0027)	1
ITEM 5	LHS BOTTOM SPACER 19.5mm (S1256)	1
ITEM 6	M8 x 50mm BOLT (LHS BOTTOM)	1
ITEM 7	M12 x 120mm BOLT (RHS TOP)	1
ITEM 8	M8 x 35mm BOLT (RHS BOTTOM)	1
ITEM 9	M12 HEAD CAPS	2

R&G



ASSEMBLY DIAGRAM

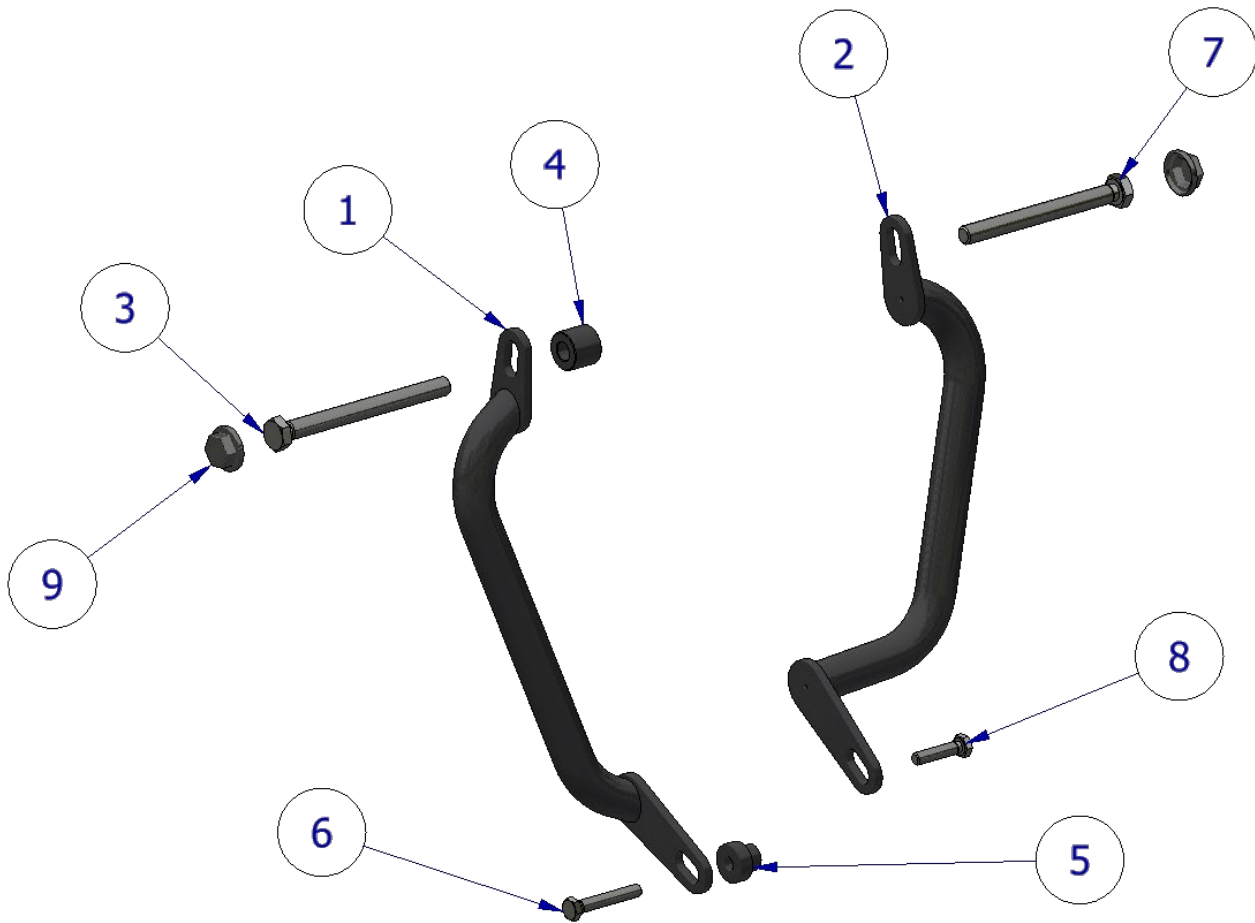

FITTING PICTURES



Picture 1



Picture 2

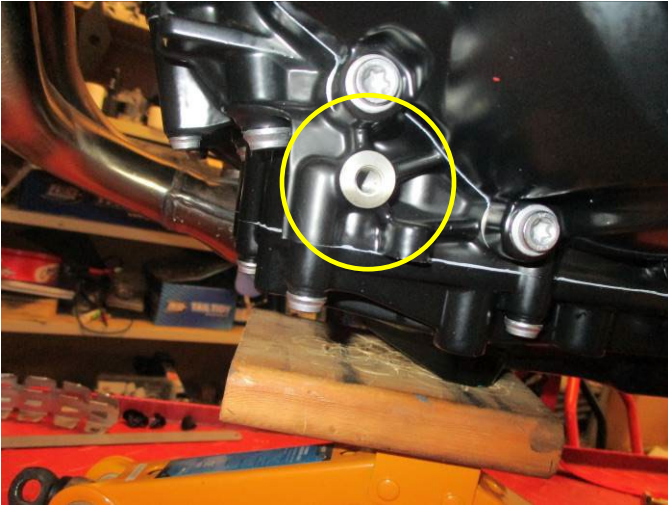

Picture 3



Picture 4

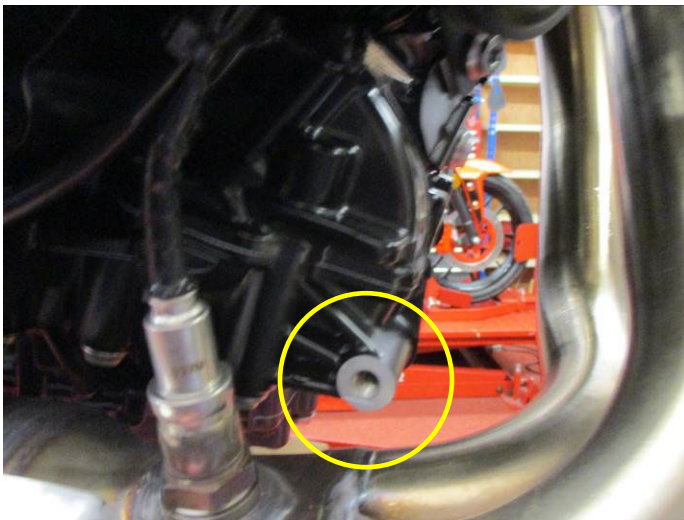

Picture 5

FITTING INSTRUCTIONS

PLEASE NOTE THAT BEFORE BEGINNING, YOU WILL NEED A SUITABLE JACK TO SUPPORT THE ENGINE WHEN REMOVING OEM ENGINE BOLTS. IF YOU ARE NOT COMFORTABLE CARRYING OUT THIS PROCEDURE, HAVE FITTED BY A QUALIFIED TECHNICIAN. READ ALL STEPS BEFORE PROCEEDING.

ALSO NOTE THAT YOU WILL NEED THE UPPER ADVENTURE BAR KIT (AB0064) INSTALLED IN ORDER TO FIT THIS LOWER ADVENTURE BAR KIT.

- Stand the bike upright and place a jack underneath the engine in a central position and apply a light pressure to the underside of the engine, **NOT** the exhaust or any other tubing. Use a semi soft material (rubber/wood etc) to prevent any damage to the under-side of the engine (example shown in **Picture 1**).

R&G

Unit 1, Shelley's Lane, East Worldham, Alton, Hampshire, GU34 3AQ

Tel: +44 (0)1420 89007 Fax: +44 (0)1420 87301 www.rg-racing.com Email: info@rg-racing.com



- Remove the LHS upper engine bolt from the location shown in **Picture 2**, if you have AB0064 already installed you will need to remove the bolt supplied in that kit and replace with **Item 3**.
- Offer up the LHS Adventure bar assembly (**Item 1**) and LHS Spacer (**Item 4**) as shown in the **Assembly Diagram** and secure in place using the 130mm Bolt (**Item 3**) & M12 Washer (**Included in AB0064 Kit**).
- Remove the engine bolt from the location shown in **Picture 3** and offer the lower section of the LHS Assembly (**Item 1**) and Spacer (**Item 5**) up to the engine case and secure using the M8 x 50mm bolt (**Item 6**).
- Tighten both engine bolts to the correct torque detailed in your service manual.
- Remove the RHS upper engine bolt from the location shown in **Picture 4**, if you have AB0064 already installed you will need to remove the bolt supplied in that kit and replace with **Item 7**.
- In the same fashion as the LHS – Offer up the RHS crash bar assembly (**Item 2**) as shown in the **Assembly Diagram** and secure with the 120mm M12 engine bolt (**Item 7**) & washer (**included in AB0064 Kit**).
- Remove the engine bolt from the location shown in **Picture 5** and offer the lower section of the RHS Assembly (**Item 2**) up to the engine case and secure using the M8 x 35mm bolt (**Item 8**).
- Tighten both engine bolts to the correct torque detailed in your service manual.
- Place the M12 Nut caps (**Item 9**) onto the engine bolts.
- Check all bolts are tight and the Adventure bar assembly is secure both sides.

See more R&G products for your Motorcycle in the link below:

- [R&G Racing | All Products for BMW - F900R \(2022\) \(rg-racing.com\)](http://rg-racing.com)

ISSUE 1 – 05/01/2023 (MH)

CONSUMER NOTICE

The catalogue description and any exhibition of samples are only broad indications of the Products and R&G may make design changes which do not diminish their performance or visual appeal and supplying them in such state shall conform to the order. The Buyer acknowledges no representation or warranty (other than as to title) has been given or will apply to the Products other than those in R&G's order or confirmation and the Buyer confirms it has chosen the Products as being of merchantable quality and suitable for its particular purposes. Where R&G fits the Products or undertakes other services it shall exercise reasonable skill and care and rectify any fault free of charge unless the workmanship has been disturbed. The Buyer is responsible for ensuring that the warranty on the motorcycle is not affected by the fitting of the Products. On return of any defective Products R&G shall at its option either supply a replacement or refund the purchase money but shall not be liable if the Products have been modified or used or maintained otherwise than in accordance with R&G's or manufacturer's instructions and good engineering practice or if the defect arises from accident or neglect. Other than identified above and subject to R&G not limiting its liability for causing death and personal injury, it shall not be liable for indirect or consequential loss and otherwise its liability shall be limited to the amounts paid by the Buyer for the Products or the fitting or service concerned. These terms do not affect the Buyer's statutory rights.

R&G RETURNS POLICY (NON-FAULTY GOODS)

Returns must be pre-authorized (if not pre-authorized the return will be rejected). Goods may only be returned direct to us if they were purchased direct from us (customer must prove if necessary). Otherwise to be returned to original vendor. Goods must be in re-sellable condition, in the opinion of R&G. All returns are subject to a 25% restocking and handling fee (25% of the gross value exc. P&P – at the prevailing price at time of purchase). The customer must pay any and all carriage charges. No returns of discontinued products, unless within 14 days of purchase. This policy does not affect your statutory rights and does not refer to faulty goods.

R&G

Unit 1, Shelley's Lane, East Worldham, Alton, Hampshire, GU34 3AQ

Tel: +44 (0)1420 89007 Fax: +44 (0)1420 87301 www.rg-racing.com Email: info@rg-racing.com



NOTICE DE MONTAGE POUR AB0065 BARRES AVENTURE



CE KIT CONTIENT LES ARTICLES ILLUSTRÉS ET ÉTIQUETES SUR LA PAGE.

CERTAINES PARTIES PEUVENT ÊTRE PRÉSENTES UNIQUEMENT POUR LA CLARTÉ DES INSTRUCTIONS.

NE PAS PROCÉDER AU MONTAGE TANT QUE VOUS N'ÊTES PAS SÛR QUE TOUTES LES PIÈCES SOIENT PRÉSENTES.

VEUILLEZ LIRE TOUTES LES INSTRUCTIONS AVANT DE CONTINUER.

EN CAS DE DOUTE LORS DU MONTAGE DE NOS PRODUITS, CONSULTEZ UN DE NOS REVENDEURS OU FAITES APPEL À UN TECHNICIEN QUALIFIÉ.

VEUILLEZ NOTER QUE LA FAÇON DONT LE KIT EST EMBALLÉ NE REPRÉSENTE PAS NECESSAIREMENT LA MANIÈRE DE LE MONTER SUR LA MOTO.

SI DES RONDELLES EN CAOUTCHOUC SONT UTILISÉES POUR MAINTENIR LES COMPOSANTS SUR LES BOULONS, ELLES PEUVENT ÊTRE JETÉES.

NOTICE DISPONIBLE AU TÉLÉCHARGEMENT SUR :
WWW.RG-RACING.COM



<u>OUTILS REQUIS</u>	<u>VALEURS DE SERRAGE</u>
<ul style="list-style-type: none"> • CLÉ TORX • CLÉ À MOLETTE 10MM • CLÉS ALLEN • CLÉ DYNAMOMÉTRIQUE • PRISE AVEC ZONE DE SUPPORT SOUPLE (POUR SOUTENIR LE MOTEUR LORSQUE LES BOULONS DE MONTAGE SONT RETIRÉS). 	<p>M4 BOULON = 8Nm</p> <p>M5 BOULON = 12Nm</p> <p>M6 BOULON = 15Nm</p> <p>M8 BOULON = 20Nm</p> <p>M10 BOULON = 40Nm</p> <p>M12 BOULON = 40Nm</p>

LÉGENDE

ARTICLE NO.	DESCRIPTION	QTÉ
ARTICLE 1	ASSEMBLAGE DE PROTECTION CRASH CÔTÉ GAUCHE (AB0065 ASSEMBLAGE CÔTÉ GAUCHE)	1
ARTICLE 2	ASSEMBLAGE DE PROTECTION CRASH CÔTÉ DROIT (AB0065 ASSEMBLAGE CÔTÉ DROIT)	1
ARTICLE 3	M12 x 130mm BOULON (AVANT GAUCHE)	1
ARTICLE 4	ENTRETOISE AVANT GAUCHE 21mm (S0027)	1
ARTICLE 5	ENTRETOISE ARRIÈRE GAUCHE 19.5mm (S1256)	1
ARTICLE 6	M8 x 50mm BOULON (ARRIÈRE GAUCHE)	1
ARTICLE 7	M12 x 120mm BOULON (SUPÉRIEUR DROIT)	1
ARTICLE 8	M8 x 35mm BOULON (EN BAS À DROITE)	1
ARTICLE 9	M12 CAPUCHONS	2

R&G



SCHÉMA D'ENSEMBLE

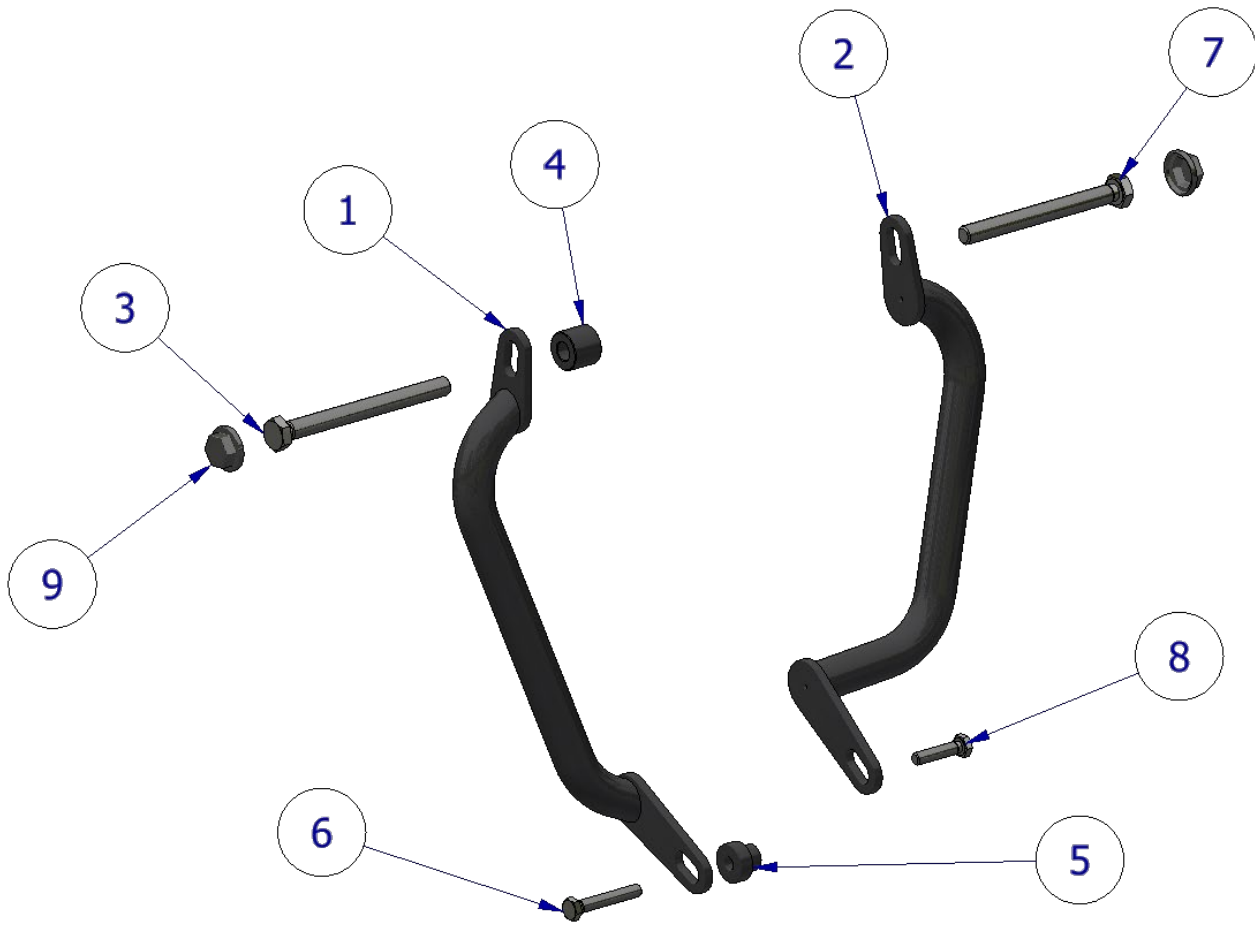

PHOTOS DE MONTAGE



Photo 1



Photo 2

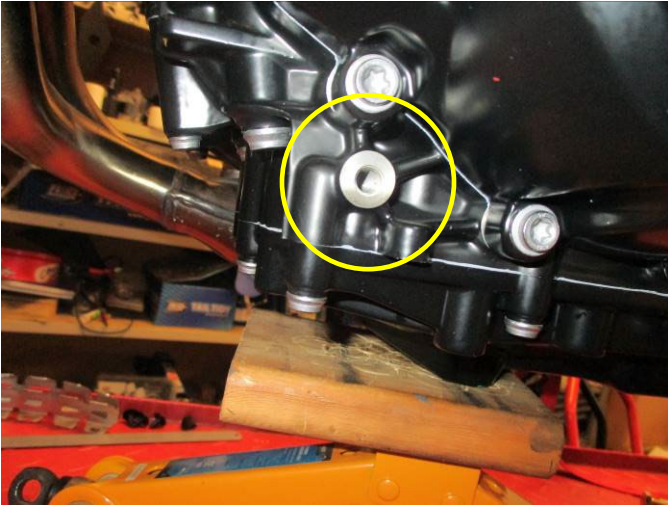

Photo 3



Photo 4

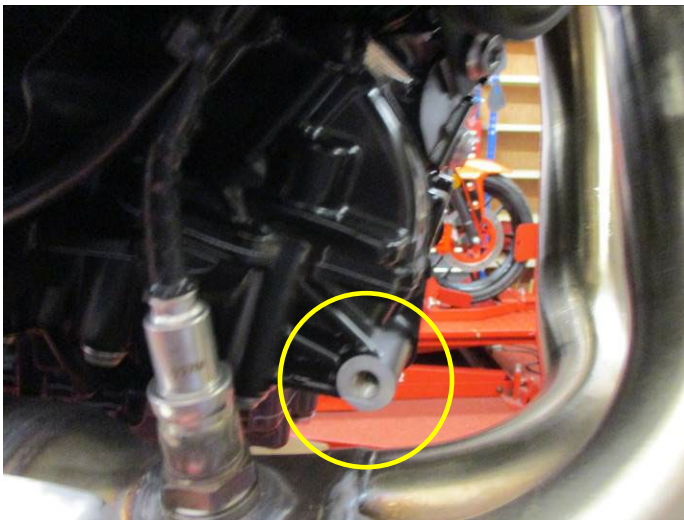

Photo 5

NOTICE DE MONTAGE

VEUILLEZ NOTER QU'AVANT DE COMMENCER, VOUS AUREZ BESOIN D'UN CRIC APPROPRIÉ POUR SOUTENIR LE MOTEUR LORSQUE VOUS ENLEVEZ LES BOULONS DU MOTEUR D'ORIGINE. SI VOUS N'ÊTES PAS À L'AISE POUR EFFECTUER CETTE MANOEUVRE, FAITES INSTALLER PAR UN TECHNICIEN QUALIFIÉ. LISEZ TOUTES LES ÉTAPES AVANT DE CONTINUER.

NOTEZ ÉGALEMENT QUE VOUS AUREZ BESOIN DU KIT DE BARRE D'AVENTURE SUPÉRIEURE (AB0064) INSTALLÉ AFIN D'ADAPTER CE KIT DE BARRE D'AVENTURE INFÉRIEURE.

- Mettez la moto debout et placez un cric sous le moteur en position centrale et appliquez une légère pression sur le dessous du moteur, PAS sur l'échappement ou tout autre tube. Utilisez un matériau semi-souple (caoutchouc/bois, etc.) pour éviter tout dommage au-dessous du moteur (exemple montré sur la photo 1).

R&G

Unit 1, Shelley's Lane, East Worldham, Alton, Hampshire, GU34 3AQ

Tel: +44 (0)1420 89007 Fax: +44 (0)1420 87301 www.rg-racing.com Email: info@rg-racing.com



- Retirez le boulon moteur supérieur gauche de l'emplacement indiqué sur la photo 2, si vous avez AB0064 déjà installé, vous devrez retirer le boulon fourni dans ce kit et le remplacer par l'article 3.
- Présentez l'assemblage de la barre Adventure côté gauche (article 1) et l'entretoise côté gauche (article 4) comme indiqué sur le schéma d'assemblage et fixez-les en place à l'aide du boulon de 130 mm (article 3) et de la rondelle M12 (inclus dans le kit AB0064).
- Retirez le boulon du moteur de l'emplacement indiqué sur la photo 3 et placez la partie inférieure de l'ensemble côté gauche (article 1) et l'entretoise (article 5) jusqu'au carter du moteur et fixez-le à l'aide du boulon M8 x 50 mm (article 6).
- Serrez les deux boulons du moteur au couple correct indiqué dans votre manuel d'entretien.
- Retirez le boulon moteur supérieur côté droit de l'emplacement indiqué sur la photo 4, si vous avez AB0064 déjà installé, vous devrez retirer le boulon fourni dans ce kit et le remplacer par l'article 7.
- De la même manière que le côté gauche - Présentez l'ensemble de barre de protection côté droit (article 2) comme indiqué sur le schéma d'assemblage et fixez-le avec le boulon moteur M12 de 120 mm (article 7) et la rondelle (inclus dans le kit AB0064).
- Retirez le boulon du moteur de l'emplacement indiqué sur la photo 5 et présentez la partie inférieure de l'ensemble côté droit (article 2) jusqu'au carter moteur et fixez-le à l'aide du boulon M8 x 35 mm (article 8).
- Serrez les deux boulons du moteur au couple correct indiqué dans votre manuel d'entretien.
- Placez les capuchons d'écrou M12 (article 9) sur les boulons du moteur.
- Vérifiez que tous les boulons soient serrés et que l'assemblage de la barre Adventure soit sécurisé des deux côtés.

Voir plus de produits R&G pour votre moto via ce lien :

[R&G Racing | All Products for BMW - F900R \(2022\) \(rg-racing.com\)](http://rg-racing.com)

ISSUE 1 - 05/01/2023 (MH)

CONSUMER NOTICE

The catalogue description and any exhibition of samples are only broad indications of the Products and R&G may make design changes which do not diminish their performance or visual appeal and supplying them in such state shall conform to the order. The Buyer acknowledges no representation or warranty (other than as to title) has been given or will apply to the Products other than those in R&G's order or confirmation and the Buyer confirms it has chosen the Products as being of merchantable quality and suitable for its particular purposes. Where R&G fits the Products or undertakes other services it shall exercise reasonable skill and care and rectify any fault free of charge unless the workmanship has been disturbed. The Buyer is responsible for ensuring that the warranty on the motorcycle is not affected by the fitting of the Products. On return of any defective Products R&G shall at its option either supply a replacement or refund the purchase money but shall not be liable if the Products have been modified or used or maintained otherwise than in accordance with R&G's or manufacturer's instructions and good engineering practice or if the defect arises from accident or neglect. Other than identified above and subject to R&G not limiting its liability for causing death and personal injury, it shall not be liable for indirect or consequential loss and otherwise its liability shall be limited to the amounts paid by the Buyer for the Products or the fitting or service concerned. These terms do not affect the Buyer's statutory rights.

R&G RETURNS POLICY (NON-FAULTY GOODS)

Returns must be pre-authorized (if not pre-authorized the return will be rejected). Goods may only be returned direct to us if they were purchased direct from us (customer must prove if necessary). Otherwise to be returned to original vendor. Goods must be in re-sellable condition, in the opinion of R&G. All returns are subject to a 25% restocking and handling fee (25% of the gross value exc. P&P - at the prevailing price at time of purchase). The customer must pay any and all carriage charges. No returns of discontinued products, unless within 14 days of purchase. This policy does not affect your statutory rights and does not refer to faulty goods.

R&G

Unit 1, Shelley's Lane, East Worldham, Alton, Hampshire, GU34 3AQ

Tel: +44 (0)1420 89007 Fax: +44 (0)1420 87301 www.rg-racing.com Email: info@rg-racing.com