



FITTING INSTRUCTIONS FOR CP0506 AERO CRASH PROTECTORS
MV AGUSTA BRUTALE 1000RR 2020-



THIS KIT CONTAINS THE ITEMS PICTURED AND LABELLED OVER PAGE.

SOME PARTS MAY BE SHOWN FOR CLARITY OF INSTRUCTIONS ONLY.

DO NOT PROCEED UNTIL YOU ARE SURE ALL PARTS ARE PRESENT.

PLEASE READ ALL INSTRUCTIONS BEFORE PROCEEDING.

**IF IN ANY DOUBT WHEN FITTING OUR PRODUCTS, CONSULT ONE OF OUR DEALERS
OR HAVE FITTED BY A QUALIFIED TECHNICIAN.**

PLEASE NOTE THAT THE WAY THE KIT IS PACKED DOES NOT NECESSARILY REPRESENT THE WAY OF
MOUNTING TO THE BIKE.

IN THE EVENT OF RUBBER WASHERS BEING USED TO HOLD COMPONENTS ONTO BOLTS,
THESE RUBBER WASHERS CAN BE THROWN AWAY.

DIGITAL COPIES OF THESE INSTRUCTIONS ARE AVAILABLE FROM:

WWW.RG-RACING.COM



| <u>TOOLS REQUIRED</u> | <u>GENERAL TORQUE SETTINGS</u> |
|--|--|
| <ul style="list-style-type: none"> • 14mm & 19mm A/F SOCKET & WRENCH • TORQUE WRENCH (UP TO 90Nm) • 4mm & 5mm Hex keys • Suitable bike engine support jack | <p>M4 BOLT = 8Nm</p> <p>M5 BOLT = 12Nm</p> <p>M6 BOLT = 15Nm</p> <p>M8 BOLT = 20Nm</p> <p>M10 BOLT = 40Nm</p> <p>M12 BOLT = 40Nm</p> |

LEGEND

| ITEM NO. | DESCRIPTION | QTY |
|-----------------|-----------------------------------|------------|
| ITEM 1 | B0061 M12 CRASH PROTECTORS | 2 |
| ITEM 2 | S0810 36MM SPACER | 2 |
| ITEM 3 | M12x1.25x100mm LONG HEX HEAD BOLT | 2 |
| ITEM 4 | M12 WASHERS Ø=25mm | 2 |
| ITEM 5 | LW0001 SHAKEPROOF WASHERS | 2 |
| ITEM 6 | BC0002BK BOBBIN CAP | 2 |



AERO-STYLE CRASH PROTECTOR ORIENTATION



LHS & RHS EXPLODED ASSEMBLY VIEW

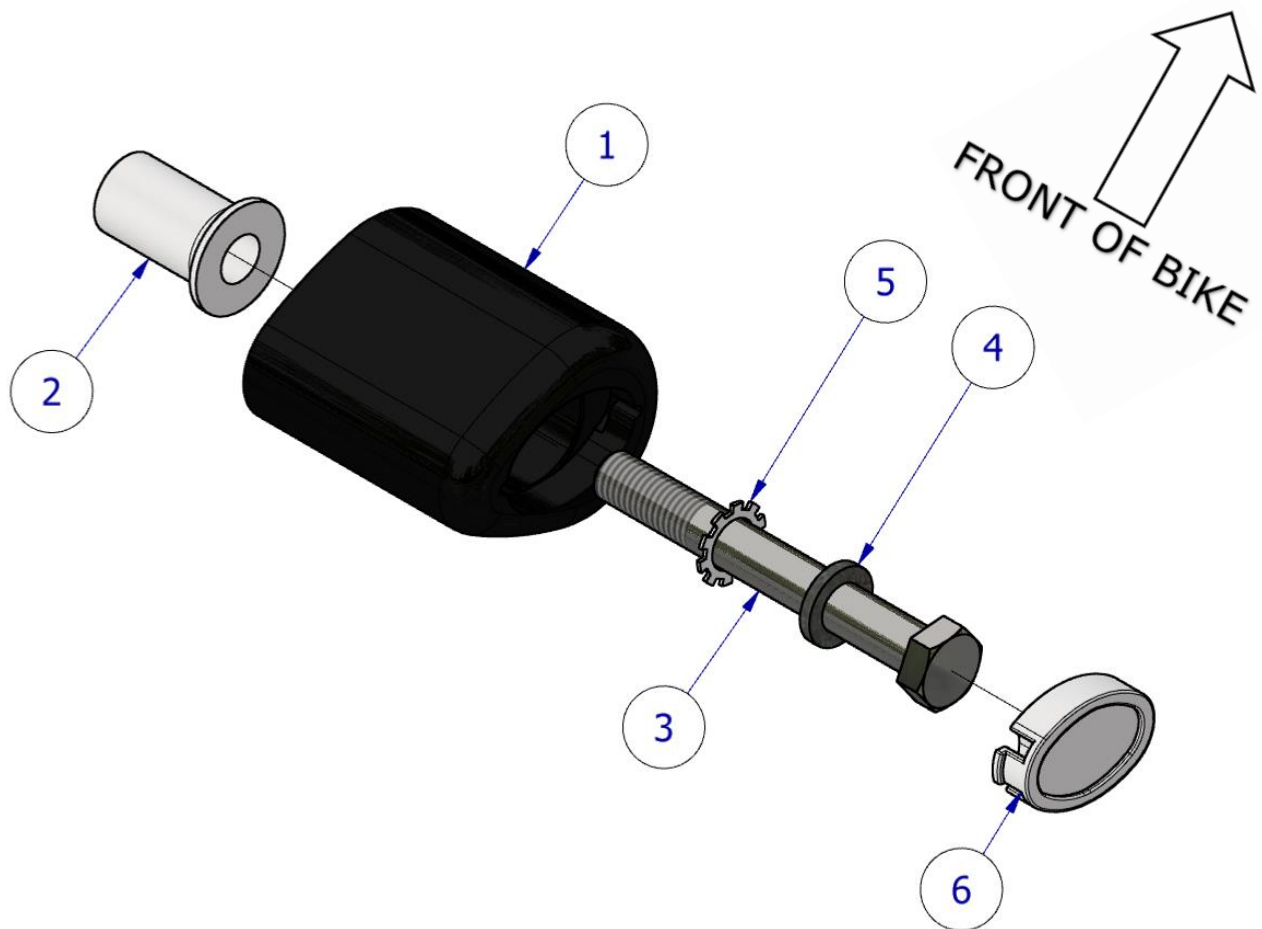



FITTING PICTURES

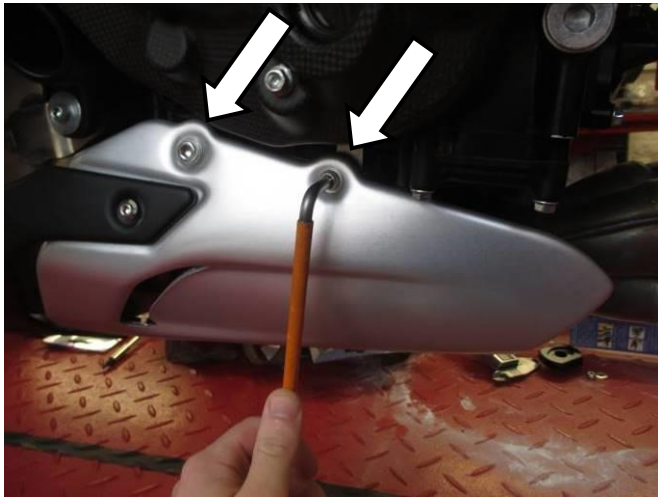

Picture 1



Picture 2



Picture 3



Picture 4



Picture 5

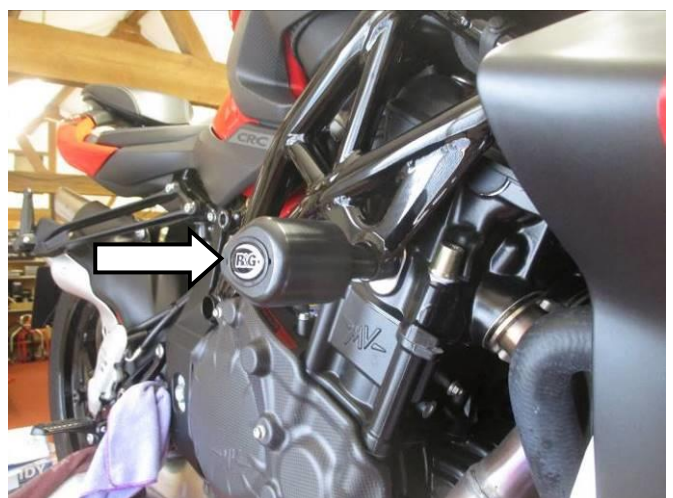

Picture 6



FITTING INSTRUCTIONS

Before removing engine bolts, ensure the bike is upright and supported by a suitable engine stand or jack placed under the sump of the motorbike to support the weight of the engine, this will prevent the engine from moving during fitting. DO NOT REMOVE MORE THAN 1 ENGINE BOLT AT ANY TIME.

- To begin, while supporting the belly pan, using a 4mm & 5mm Hex keys remove the 2x cap head bolts from each side of the bike affixing the belly pan to the engine as shown in **picture 1**. *Note the 4mm hex bolt located behind the side stand on the LHS of the bike.*
- Remove the belly pan from the bike as shown in **picture 2**.
- Support the underside of the engine with a suitable bike jack, as shown in **picture 3**.
- On the LHS of the bike, remove the engine mounting bolt using a 14mm socket, as shown in **picture 4**.
- Pre-assemble the crash protector assembly as shown in the **Assembly diagram** on page 3. Slide one M12 washer (**item 4**) followed by a shake-proof washer (**item 5**) over one M12 bolt (**item 3**). Slide this assembly through one of the crash protectors (**B0061 - item 1**), then place a spacer (**S0810 - item 2**) over the exposed bolt thread length.
- Offer the crash protector assembly up to engine mount, then tighten the crash protector bolt until you feel some compression from inside the protector using a 19mm socket and wrench, as shown in **picture 5**. Turn a little more so that you feel the compression increase slightly, then apply a quarter turn. Do not over tighten as damage can occur to the bike. Do not exceed 40Nm of torque.

PLEASE NOTE THE CRASH PROTECTOR MUST BE POSITIONED AS IN THE DIAGRAM ON PAGE 3 WITH THE LARGER END TOWARDS THE FRONT OF THE BIKE.

- Repeat the previous steps for the right-hand side of the bike using the remaining components.
- Finally, fit a bobbin cap (**BC0002 - item 6**) to both crash protectors to neatly hide the bolt heads, as shown in **picture 6**.
- Re-fit the belly-pan as removed.
- Before riding, check both sides are secure, and the crash protectors cannot rotate.
- Check tightness of each side regularly.

ISSUE 2 - 16/04/2021 (DM)

CONSUMER NOTICE

The catalogue description and any exhibition of samples are only broad indications of the Products and R&G may make design changes which do not diminish their performance or visual appeal and supplying them in such state shall conform to the order. The Buyer acknowledges no representation or warranty (other than as to title) has been given or will apply to the Products other than those in R&G's order or confirmation and the Buyer confirms it has chosen the Products as being of merchantable quality and suitable for its particular purposes. Where R&G fits the Products or undertakes other services it shall exercise reasonable skill and care and rectify any fault free of charge unless the workmanship has been disturbed. The Buyer is responsible for ensuring that the warranty on the motorcycle is not affected by the fitting of the Products. On return of any defective Products R&G shall at its option either supply a replacement or refund the purchase money but shall not be liable if the Products have been modified or used or maintained otherwise than in accordance with R&G's or manufacturer's instructions and good engineering practice or if the defect arises from accident or neglect. Other than identified above and subject to R&G not limiting its liability for causing death and personal injury, it shall not be liable for indirect or consequential loss and otherwise its liability shall be limited to the amounts paid by the Buyer for the Products or the fitting or service concerned. These terms do not affect the Buyer's statutory rights.

R&G RACING RETURNS POLICY (NON-FAULTY GOODS)

Returns must be pre-authorized (if not pre-authorized the return will be rejected). Goods may only be returned direct to us if they were purchased direct from us (customer must prove if necessary). Otherwise to be returned to original vendor. Goods must be in re-sellable condition, in the opinion of R&G Racing. All returns are subject to

R&G Racing

Unit 1, Shelley's Lane, East Worldham, Alton, Hampshire, GU34 3AQ

Tel: +44 (0)1420 89007 Fax: +44 (0)1420 87301 www.rg-racing.com Email: info@rg-racing.com



a 25% restocking and handling fee (25% of the gross value exc. P&P – at the prevailing price at time of purchase). The customer must pay any and all carriage charges. No returns of discontinued products, unless within 14 days of purchase. This policy does not affect your statutory rights and does not refer to faulty goods.



NOTICE DE MONTAGE POUR CP0506 PROTECTIONS CRASH
MV AGUSTA BRUTALE 1000RR 2020-



CE KIT CONTIENT LES ARTICLES ILLUSTRÉS ET ÉTIQUETES SUR LA PAGE.

CERTAINES PARTIES PEUVENT ÊTRE PRÉSENTES UNIQUEMENT POUR LA CLARTE DES INSTRUCTIONS.

NE PAS PROCÉDER AU MONTAGE TANT QUE VOUS N'ÊTES PAS SÛR QUE TOUTES LES PIÈCES SOIENT PRÉSENTES.

VEUILLEZ LIRE TOUTES LES INSTRUCTIONS AVANT DE CONTINUER.

EN CAS DE DOUTE LORS DU MONTAGE DE NOS PRODUITS, CONSULTEZ UN DE NOS REVENDEURS OU FAITES APPEL À UN TECHNICIEN QUALIFIÉ.

VEUILLEZ NOTER QUE LA FAÇON DONT LE KIT EST EMBALLÉ NE REPRÉSENTE PAS NECESSAIREMENT LA MANIÈRE DE LE MONTER SUR LA MOTO.

SI DES RONDELLES EN CAOUTCHOUC SONT UTILISÉES POUR MAINTENIR LES COMPOSANTS SUR LES BOULONS, ELLES PEUVENT ÊTRE JETÉES.

NOTICE DISPONIBLE AU TÉLÉCHARGEMENT SUR : WWW.RG-RACING.COM



| <u>TOOLS REQUIRED</u> | <u>GENERAL TORQUE SETTINGS</u> |
|--|--|
| <ul style="list-style-type: none"> • 14mm & 19mm A/F SOCKET & WRENCH • TORQUE WRENCH (UP TO 90Nm) • 4mm & 5mm Hex keys • Suitable bike engine support jack | <p>M4 BOLT = 8Nm</p> <p>M5 BOLT = 12Nm</p> <p>M6 BOLT = 15Nm</p> <p>M8 BOLT = 20Nm</p> <p>M10 BOLT = 40Nm</p> <p>M12 BOLT = 40Nm</p> |

LÉGENDE

| ARTICLE NO. | DESCRIPTION | QTÉ |
|--------------------|---------------------------------|------------|
| ARTICLE 1 | B0061 M12 PROTECTIONS CRASH | 2 |
| ARTICLE 2 | S0810 36MM ENTRETOISE | 2 |
| ARTICLE 3 | M12x1.25x100mm BOULON | 2 |
| ARTICLE 4 | M12 RONDELLES Ø=25mm | 2 |
| ARTICLE 5 | LW0001 RONDELLES ANTI VIBRATION | 2 |
| ARTICLE 6 | BC0002BK CAPUCHON DE BOBINE | 2 |



ORIENTATION DE LA PROTECTION CRASH



VUE D'ENSEMBLE CÔTÉ GAUCHE ET DROIT

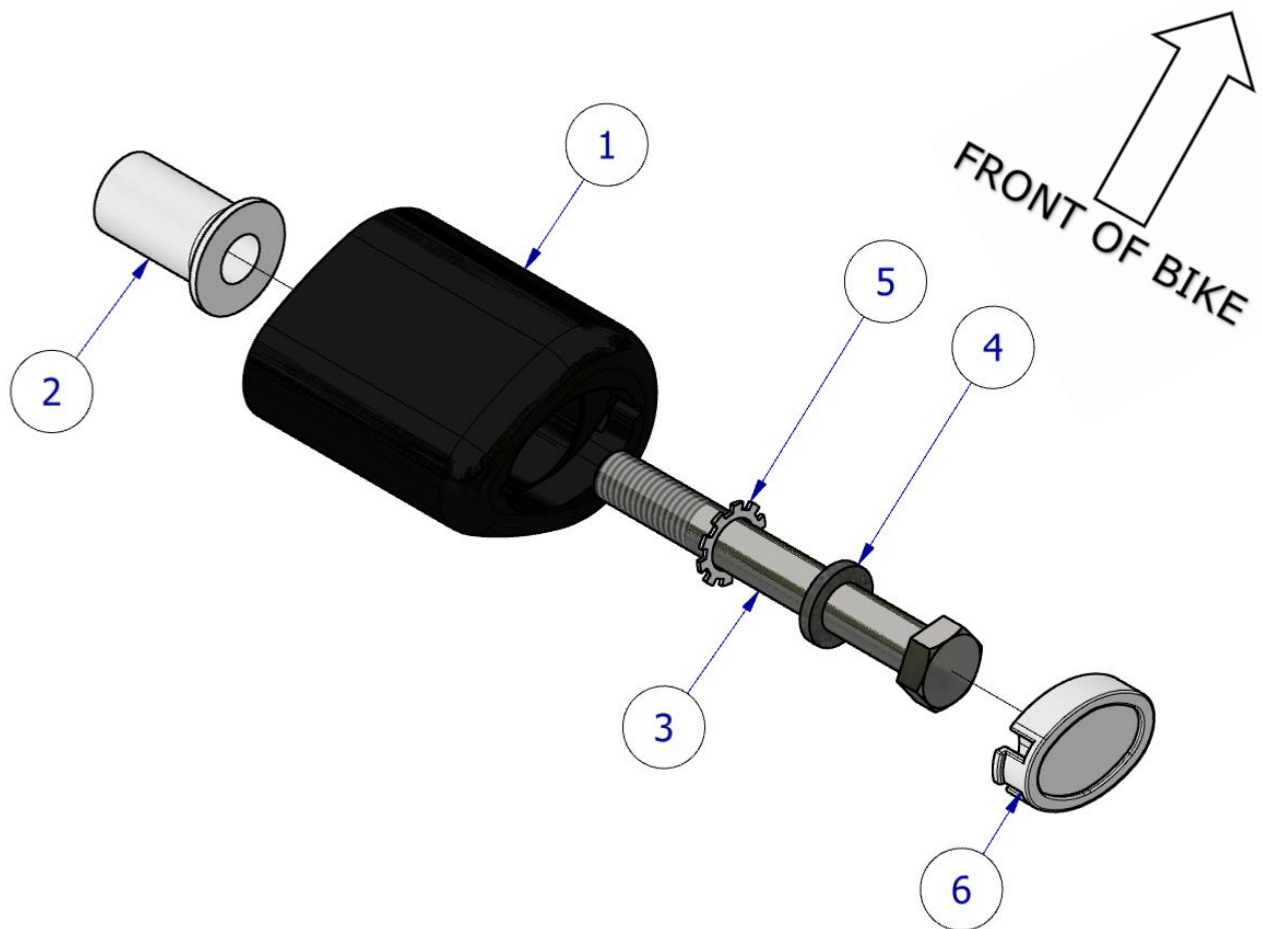



PHOTOS DE MONTAGE

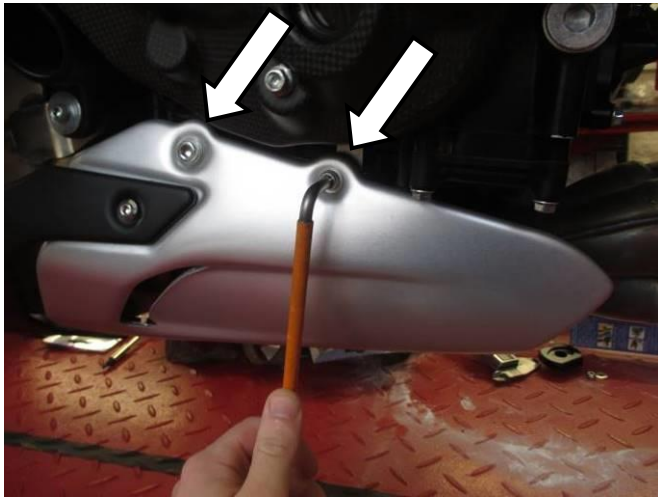

Photo 1



Photo 2



Photo 3



Photo 4



Photo 5

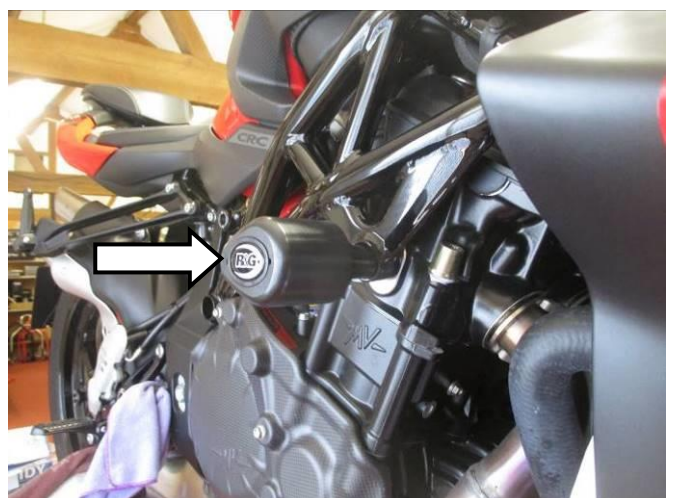

Photo 6



NOTICE DE MONTAGE

Avant de retirer les boulons du moteur, assurez-vous que la moto soit bien droite et soutenue par un support moteur approprié ou un cric placé sous le carter de la moto pour supporter le poids du moteur, cela empêchera le moteur de bouger pendant le montage. NE PAS ENLEVER PLUS D'1 BOULON DE MOTEUR À LA FOIS.

- Pour commencer, tout en soutenant le sabot moteur, à l'aide de clés hexagonales de 4 mm et 5 mm, retirez les 2 boulons à tête cylindrique de chaque côté de la moto en fixant le sabot moteur au moteur comme indiqué sur la photo 1. Notez le boulon hexagonal de 4 mm situé derrière le béquille latérale sur le côté gauche de la moto.
- Retirez le sabot moteur de la moto comme indiqué sur la photo 2.
- Soutenez le dessous du moteur à l'aide d'un cric adapté, comme indiqué sur la photo 3.
- Sur le côté gauche de la moto, retirez le boulon de fixation du moteur à l'aide d'une douille de 14 mm, comme indiqué sur la photo 4.
- Pré-assembler l'ensemble de la protection crash comme indiqué sur le schéma de montage page 3. Glissez une rondelle M12 (article 4) suivie d'une rondelle anti-vibration (article 5) sur un boulon M12 (article 3). Faites glisser cet ensemble à travers l'une des protections crash (B0061 - article 1), puis placez une entretoise (S0810 - article 2) sur la longueur de filetage du boulon exposée.
- Placez l'ensemble de la protection crash jusqu'au support du moteur, puis serrez le boulon de protection crash jusqu'à ce que vous ressentiez une certaine compression de l'intérieur de la protection à l'aide d'une douille et d'une clé de 19 mm, comme indiqué sur la photo 5. Tournez un peu plus pour sentir la compression augmenter légèrement, puis appliquez un quart de tour. Ne serrez pas trop car la moto peut être endommagée. Ne pas dépasser 40Nm de couple.

VEUILLEZ NOTER QUE LA PROTECTION CRASH DOIT ÊTRE POSITIONNÉE COMME SUR LE SCHÉMA À LA PAGE 3 AVEC L'EXTRÉMITÉ LA PLUS GRANDE VERS L'AVANT DE LA MOTO.

- Répétez les étapes précédentes du côté droit de la moto en utilisant les composants restants.
- Enfin, placez un capuchon (BC0002 - article 6) sur les deux protections crash pour masquer soigneusement les têtes de boulons, comme indiqué sur la photo 6.
- Remontez le sabot moteur tel qu'il a été retiré.
- Avant de rouler, vérifiez que les deux côtés soient sécurisés et que les protections crash ne puissent pas tourner.
- Vérifier régulièrement le serrage de chaque côté.

ISSUE 2 - 16/04/2021 (DM)

CONSUMER NOTICE

The catalogue description and any exhibition of samples are only broad indications of the Products and R&G may make design changes which do not diminish their performance or visual appeal and supplying them in such state shall conform to the order. The Buyer acknowledges no representation or warranty (other than as to title) has been given or will apply to the Products other than those in R&G's order or confirmation and the Buyer confirms it has chosen the Products as being of merchantable quality and suitable for its particular purposes. Where R&G fits the Products or undertakes other services it shall exercise reasonable skill and care and rectify any fault free of charge unless the workmanship has been disturbed. The Buyer is responsible for ensuring that the warranty on the motorcycle is not affected by the fitting of the Products. On return of any defective Products R&G shall at its option either supply a replacement or refund the purchase money but shall not be liable if the Products have been modified or used or maintained otherwise than in accordance with R&G's or manufacturer's instructions and good engineering practice or if the defect arises from accident or neglect. Other than identified above and subject to R&G not limiting its liability for causing death and personal injury, it shall not be liable for indirect or consequential loss and otherwise its liability shall be limited to the amounts paid by the Buyer for the Products or the fitting or service concerned. These terms do not affect the Buyer's statutory rights.

R&G Racing

Unit 1, Shelley's Lane, East Worldham, Alton, Hampshire, GU34 3AQ

Tel: +44 (0)1420 89007 Fax: +44 (0)1420 87301 www.rg-racing.com Email: info@rg-racing.com

**R&G RACING RETURNS POLICY (NON-FAULTY GOODS)**

Returns must be pre-authorized (if not pre-authorized the return will be rejected). Goods may only be returned direct to us if they were purchased direct from us (customer must prove if necessary). Otherwise to be returned to original vendor. Goods must be in re-sellable condition, in the opinion of R&G Racing. All returns are subject to a 25% restocking and handling fee (25% of the gross value exc. P&P – at the prevailing price at time of purchase). The customer must pay any and all carriage charges. No returns of discontinued products, unless within 14 days of purchase. This policy does not affect your s

R&G Racing

Unit 1, Shelley's Lane, East Worldham, Alton, Hampshire, GU34 3AQ

Tel: +44 (0)1420 89007 Fax: +44 (0)1420 87301 www.rg-racing.com Email: info@rg-racing.com



MONTAGEANLEITUNG FÜR CP0506 AERO STURZPADS
MV AGUSTA BRUTALE 1000RR 2020-



ALLE KIT-TEILE SIND AUF DEN NACHFOLGENDEN SEITEN ABGEBILDET UND GEKENNZEICHNET.

DIE ABGEBILDETEN TEILE DIENEN LEDIGLICH ZUR ERKLÄRUNG.

ÜBERPRÜFEN SIE ZUERST, DASS ALLE TEILE VORHANDEN SIND.

LESEN SIE DIE MONTAGEANLEITUNG KOMPLETT DURCH, BEVOR SIE ANFANGEN.

WENN SIE BEI DER MONTAGE DIESES PRODUKTES UNSICHER SIND, BITTE EINEN UNSERER HÄNDLER KONTAKTIEREN ODER DAS KIT VON EINEM QUALIFIZIERTEN ZWEIRAD-MECHANIKER MONTIEREN LASSEN.

DIE VERPACKUNG DER TEILE STELLT NICHT DIE REIHENFOLGE DER MONTAGE DAR.

HINWEIS FÜR KITS MIT PLASTIKUNTERLEGSscheIBEN AN DEN SCHRAUBEN –
DIESE PLASTIK-UNTERLEGSscheIBEN WERDEN NICHT FÜR DEN EINBAU BENÖTIGT!

EINE DIGITALE VERSION DIESER MONTAGEANLEITUNG KANN AUF FOLGENDER SEITE HERUNTERGELADEN WERDEN:

www.rg-racing.com

R&G Racing

Unit 1, Shelley's Lane, East Worldham, Alton, Hampshire, GU34 3AQ

Tel: +44 (0)1420 89007 Fax: +44 (0)1420 87301 www.rg-racing.com Email: info@rg-racing.com



| <u>SIE BENÖTIGEN FOLGENDES WERKZEUG</u> | <u>ALLGEM. ANZUGSDREHMOMENT:</u> |
|---|--|
| <ul style="list-style-type: none"> • 14mm & 19mm A/F STECKSCHLÜSSEL • DREHMOMENTSCHLÜSSEL (BIS 90Nm) • 4mm & 5mm Inbusschlüssel • Einen geeigneten Motorradheber, um den Motor während der Montage zu stützen | <p>M4 SCHRAUBE = 8Nm</p> <p>M5 SCHRAUBE = 12Nm</p> <p>M6 SCHRAUBE = 15Nm</p> <p>M8 SCHRAUBE = 20Nm</p> <p>M10 SCHRAUBE = 40Nm</p> <p>M12 SCHRAUBE = 40Nm</p> |

LIEFERUMFANG

| ARTIKEL NR. | BESCHREIBUNG | MENGE |
|--------------------|------------------------------|--------------|
| ARTIKEL 1 | B0061 M12 STURZPAD | 2 |
| ARTIKEL 2 | S0810 36MM DISTANZHALTER | 2 |
| ARTIKEL 3 | M12x1,25x100mm INBUSSCHRAUBE | 2 |
| ARTIKEL 4 | M12 UNTERLEGSCHIEBE Ø=25mm | 2 |
| ARTIKEL 5 | LW0001 ZAHNSCHIEBE | 2 |
| ARTIKEL 6 | BC0002BK SCHUTZKAPPE | 2 |

AERO STURZPAD - ORIENTIERUNG



LINKE & RECHTE SEITE - EXPLOSIONSZEICHUNG

R&G Racing

Unit 1, Shelley's Lane, East Worldham, Alton, Hampshire, GU34 3AQ

Tel: +44 (0)1420 89007 Fax: +44 (0)1420 87301 www.rg-racing.com Email: info@rg-racing.com

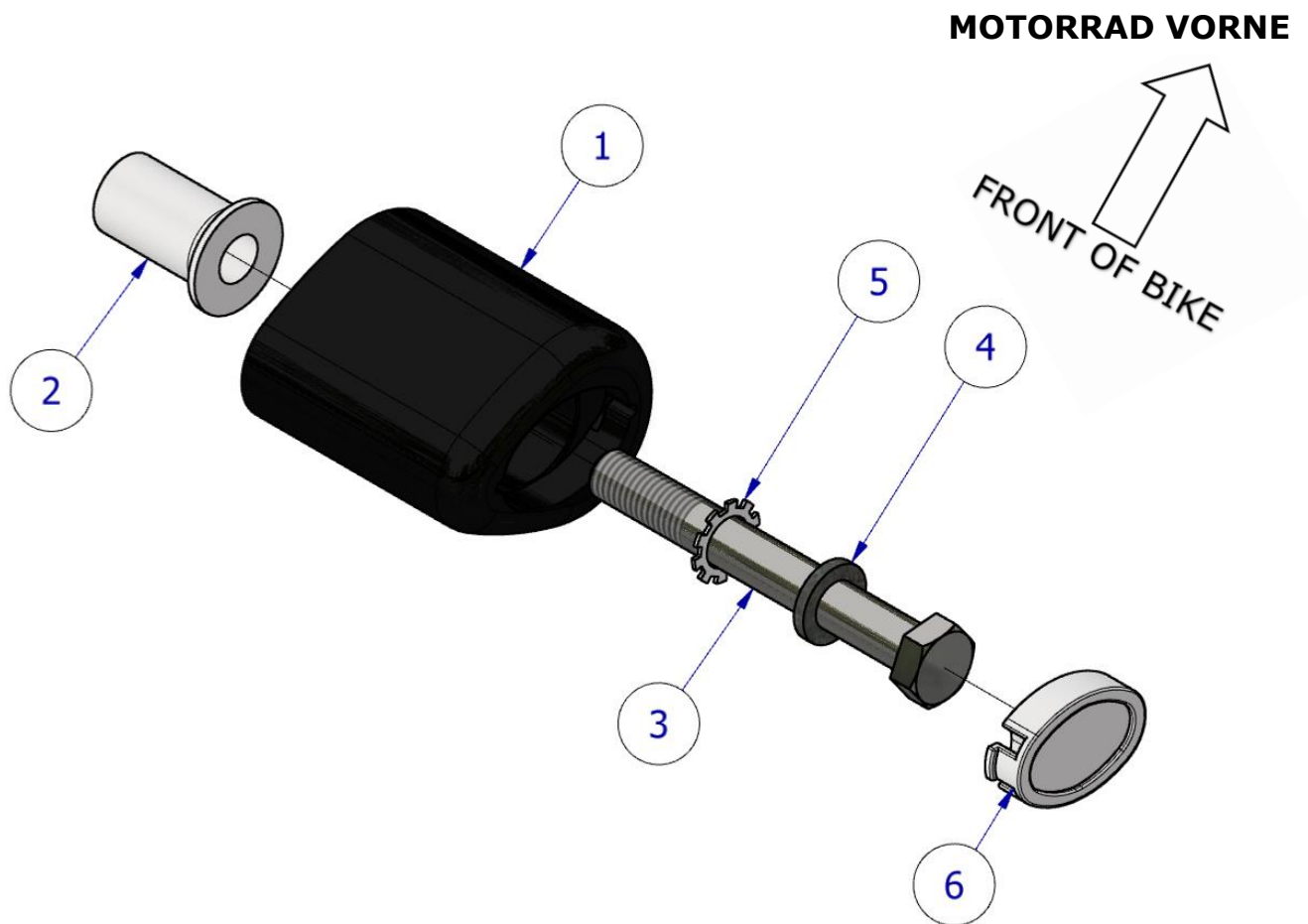

MONTAGE - BILDER



Abbildung 1

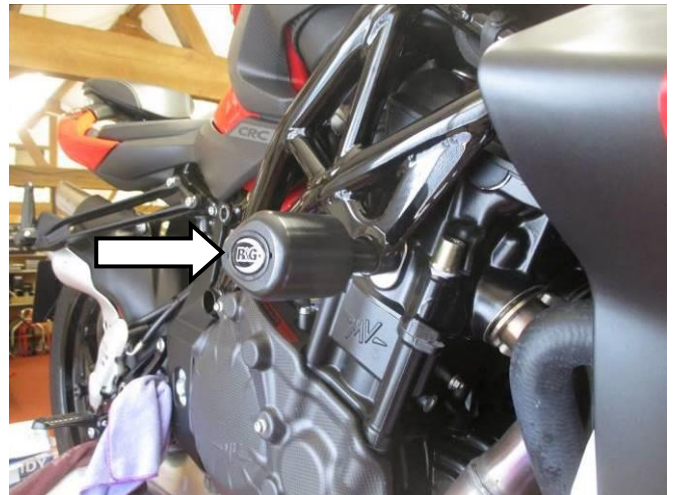

Abbildung 2

**Abbildung 3****Abbildung 4****Abbildung 5****Abbildung 6**

MONTAGEANLEITUNG

Bevor Sie Die Schrauben für den Motor entfernen, stellen Sie sicher, dass das Motorrad aufrecht steht und der Motor mit einem geeigneten Ständer/Heber unterhalb der Ölwanne gestützt wird. Dies verhindert, dass der Motor sich bei der Entfernung von Motorschrauben bewegt. WÄHREND DER INSTALLATION DÜRFEN DIE SCHRAUBEN FÜR DEN MOTOR NUR EINZELN UND NIE GLEICHZEITIG ENTFERNT WERDEN.

- Stützen Sie zuerst die untere Abdeckung. Die zwei Innensechskantschrauben an beiden Seiten des Motorrads, die die untere Verkleidung am Motor befestigen, mit den 4mm & 5mm Inbusschlüsseln entfernen wie in **Abbildung 1** abgebildet. *Hinweis: die 4mm Inbusschraube befindet sich hinter dem Seitenständer an der linken Seite des Motorrads.*
- Entfernen Sie die untere Abdeckung vom Motorrad wie in **Abbildung 2** abgebildet.
- Den Motor mit einem passenden Motorradheber oder Montageständer an der unteren Seite stützen wie in **Abbildung 3** abgebildet.



- Entfernen Sie die Befestigungsschraube für den Motor an der linken Seite des Motorrades mit einem 14mm Steckschlüssel wie in **Abbildung 4** abgebildet.
- Die Sturzpad-Einheit zusammenbauen wie in der **Zeichnung Zusammenbau** auf Seite 3 dargestellt. Eine M12 Unterlegscheibe (**Artikel 4**) gefolgt von einer Zahnscheibe (**Artikel 5**) an einer M12 Schraube (**Artikel 3**) anbringen. Die Einheit in ein Sturzpad (**B0061 - Artikel 1**) einsetzen, dann einen Distanzhalter (**S0810 - Artikel 2**) am hervorstehenden Gewinde montieren.
- Die Sturzpad-Einheit an die Motorbefestigung ansetzen. Ziehen Sie die Schraube mit einem 19mm Steckschlüssel fest, bis Sie etwas Druck vom Inneren des Sturzpads spüren – siehe **Abbildung 5**. Noch etwas drehen, bis Sie merken, dass der Druck sich leicht erhöht, dann noch eine Vierteldrehung anwenden. Nicht zu fest anziehen – dies kann zu einer Beschädigung des Motorrades führen. 40 Nm Anzugsdrehmoment nicht überschreiten!

BITTE DARAUF ACHTEN, DASS DAS STURZPAD POSITIONIERT IST WIE IN ZEICHNUNG AUF SEITE 3 DARGESTELLT - DAS GRÖßERE ENDE DES STURZPADS IST ZUM VORDERTEIL DES MOTORRADS GERICHTET

- Wiederholen Sie die vorherigen Schritte an der rechten Seite des Motorrades mit den übrigen Bauteilen.
- Anschließend die Schutzkappen (**BC0002 - Artikel 6**) an beiden Sturzpads montieren, um die Schraubenköpfe zu verdecken, wie in **Abbildung 6** abgebildet.
- Montieren Sie die untere Abdeckung wie ursprünglich wieder.
- Bevor Sie mit dem Motorrad fahren, überprüfen Sie, dass beide Seiten sicher befestigt sind und die Sturzpads sich nicht drehen können.
- Überprüfen Sie regelmäßig, dass an beiden Seiten alles sicher befestigt ist.

AUSGABE 2 - 16/04/2021 (DM)

CONSUMER NOTICE

The catalogue description and any exhibition of samples are only broad indications of the Products and R&G may make design changes which do not diminish their performance or visual appeal and supplying them in such state shall conform to the order. The Buyer acknowledges no representation or warranty (other than as to title) has been given or will apply to the Products other than those in R&G's order or confirmation and the Buyer confirms it has chosen the Products as being of merchantable quality and suitable for its particular purposes. Where R&G fits the Products or undertakes other services it shall exercise reasonable skill and care and rectify any fault free of charge unless the workmanship has been disturbed. The Buyer is responsible for ensuring that the warranty on the motorcycle is not affected by the fitting of the Products. On return of any defective Products R&G shall at its option either supply a replacement or refund the purchase money but shall not be liable if the Products have been modified or used or maintained otherwise than in accordance with R&G's or manufacturer's instructions and good engineering practice or if the defect arises from accident or neglect. Other than identified above and subject to R&G not limiting its liability for causing death and personal injury, it shall not be liable for indirect or consequential loss and otherwise its liability shall be limited to the amounts paid by the Buyer for the Products or the fitting or service concerned. These terms do not affect the Buyer's statutory rights.

R&G RACING RETURNS POLICY (NON-FAULTY GOODS)

Returns must be pre-authorized (if not pre-authorized the return will be rejected). Goods may only be returned direct to us if they were purchased direct from us (customer must prove if necessary). Otherwise to be returned to original vendor. Goods must be in re-sellable condition, in the opinion of R&G Racing. All returns are subject to a 25% restocking and handling fee (25% of the gross value exc. P&P – at the prevailing price at time of purchase). The customer must pay any and all carriage charges. No returns of discontinued products, unless within 14 days of purchase. This policy does not affect your statutory rights and does not refer to faulty goods.

R&G Racing

Unit 1, Shelley's Lane, East Worldham, Alton, Hampshire, GU34 3AQ

Tel: +44 (0)1420 89007 Fax: +44 (0)1420 87301 www.rg-racing.com Email: info@rg-racing.com



tatutory rights and does not refer to faulty goods.