



**FITTING INSTRUCTIONS FOR LP0332 LICENCE PLATE BRACKET**  
**KAWASAKI KLR650 2022-**



**This kit contains the items pictured and labelled over page.**  
**Some parts may be shown for clarity of instructions only.**  
**Do not proceed until you are sure all parts are present.**  
**Please read all instructions before proceeding.**

**IF IN ANY DOUBT WHEN FITTING OUR PRODUCTS, CONSULT ONE OF OUR DEALERS**  
**OR HAVE FITTED BY A QUALIFIED TECHNICIAN.**

Please note that the way the kit is packed does not necessarily represent the way of mounting to the bike.

In the event of rubber washers being used to hold components onto bolts, these rubber washers can be thrown away.

**DIGITAL COPIES OF THESE INSTRUCTIONS ARE AVAILABLE FROM**

**[WWW.RG-RACING.COM](http://WWW.RG-RACING.COM)**

R&G

Unit 1, Shelley's Lane, East Worldham, Alton, Hampshire, GU34 3AQ  
Tel: +44 (0)1420 89007 Fax: +44 (0)1420 87301 [www.rg-racing.com](http://www.rg-racing.com) Email: [info@rg-racing.com](mailto:info@rg-racing.com)



<b><u>TOOLS REQUIRED</u></b>	<b><u>GENERAL TORQUE SETTINGS</u></b>
<ul style="list-style-type: none"> <li>• Set metric Allen keys.</li> <li>• Socket set to include 8, 10 ,12 and 13mm A/F socket and wrench.</li> <li>• Lose nose pliers</li> <li>• Phillips screwdriver.</li> <li>• Small flat head screwdriver.</li> </ul>	<p>M4 BOLT = 8Nm</p> <p>M5 BOLT = 12Nm</p> <p>M6 BOLT = 15Nm</p> <p>M8 BOLT = 20Nm</p> <p>M10 BOLT = 40Nm</p> <p>M12 BOLT = 40Nm</p>

### **LEGEND**

<b>ITEM No.</b>	<b>DESCRIPTION</b>	<b>QTY</b>
ITEM 1	TB0332 (LICENSE PLATE BRACKET)	1
ITEM 2	LA0006 (SMOKED LENS TAIL-LIGHT ASSEMBLY)	1
ITEM 3	LA0003 (TAIL-LIGHT SHROUD)	1
ITEM 4	CON0068 (TAIL-LIGHT CONNECTOR)	1
ITEM 5	REFL3 (REFLECTOR)	1
ITEM 6	RB0008 (RUBBER GROMMET)	1
ITEM 7	CLIP1 (SELF ADHESIVE CLIP)	5
ITEM 8	M6 x 25mmmm BUTTON HEAD BOLT	4
ITEM 9	M6 x 12mm OD WASHER	8
ITEM 10	M6 NYLOC NUT	4
ITEM 11	666-896/23 (230mm LENGTH OF HEAT SHRINK)	1
ITEM 12	CON0004 (3.5mm BULLET CONNECTORS)	2

R&G

Unit 1, Shelley's Lane, East Worldham, Alton, Hampshire, GU34 3AQ

Tel: +44 (0)1420 89007 Fax: +44 (0)1420 87301 [www.rg-racing.com](http://www.rg-racing.com) Email: [info@rg-racing.com](mailto:info@rg-racing.com)



**ASSEMBLY DIAGRAM**

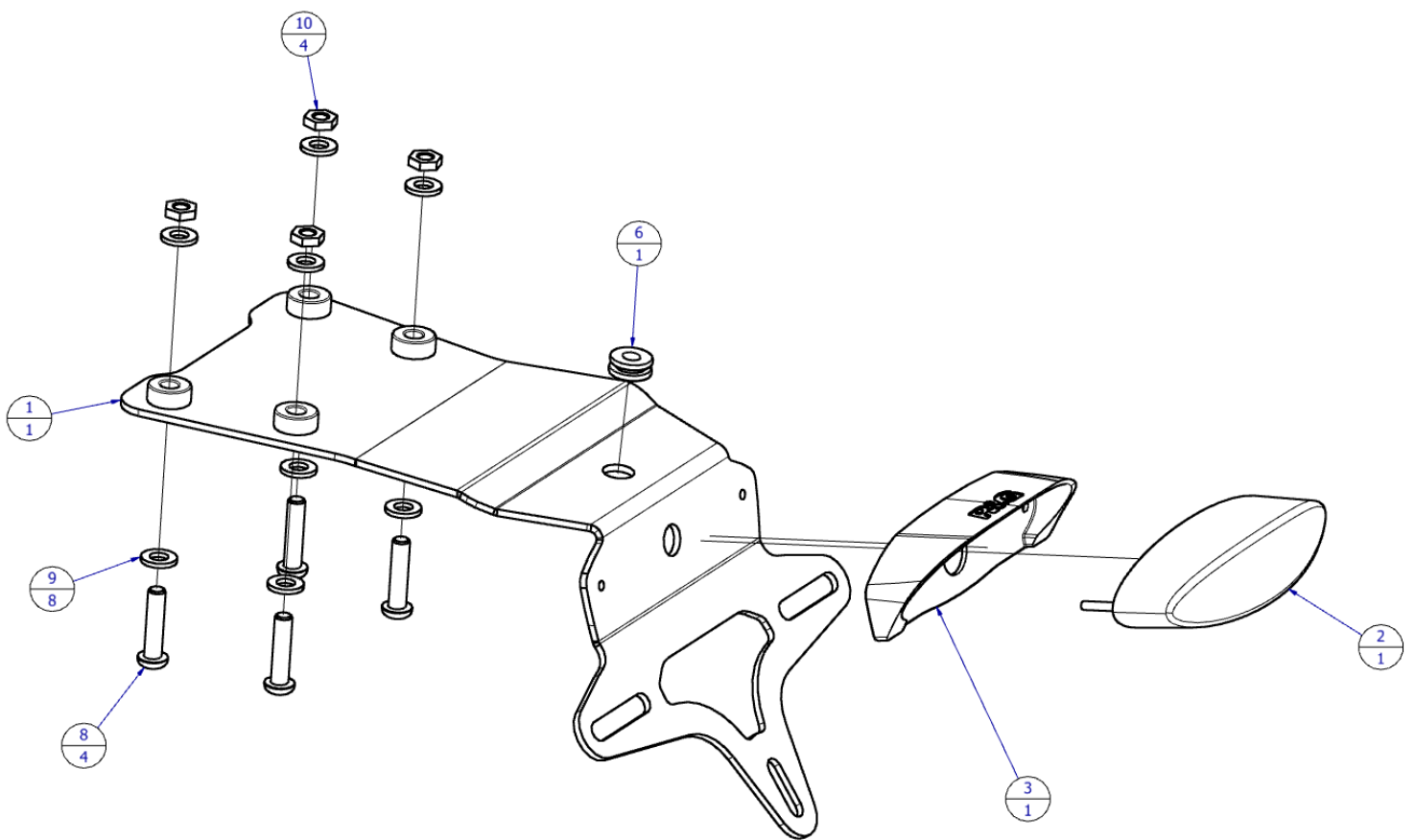

R&G

Unit 1, Shelley's Lane, East Worldham, Alton, Hampshire, GU34 3AQ

Tel: +44 (0)1420 89007 Fax: +44 (0)1420 87301 [www.rg-racing.com](http://www.rg-racing.com) Email: [info@rg-racing.com](mailto:info@rg-racing.com)



**FITTING PICTURES**



Picture 1

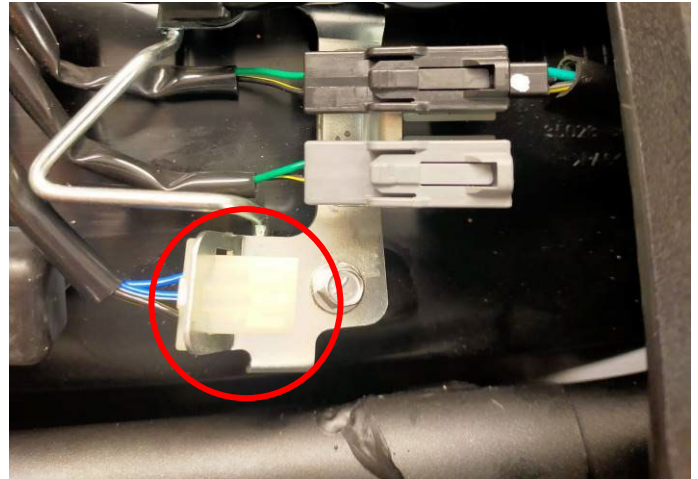

Picture 2

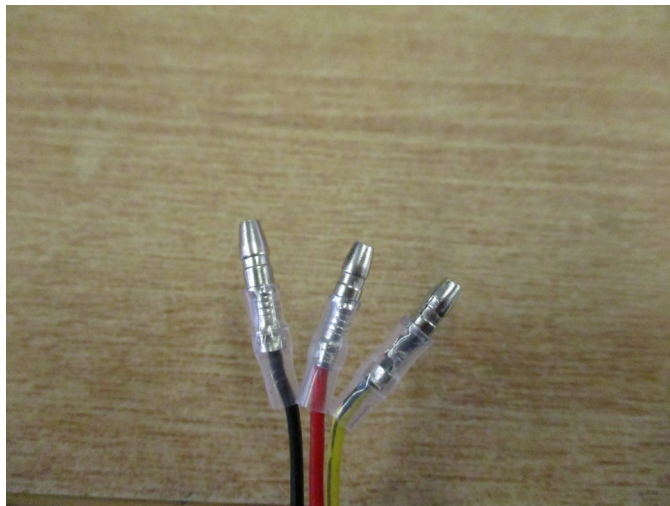

Picture 3

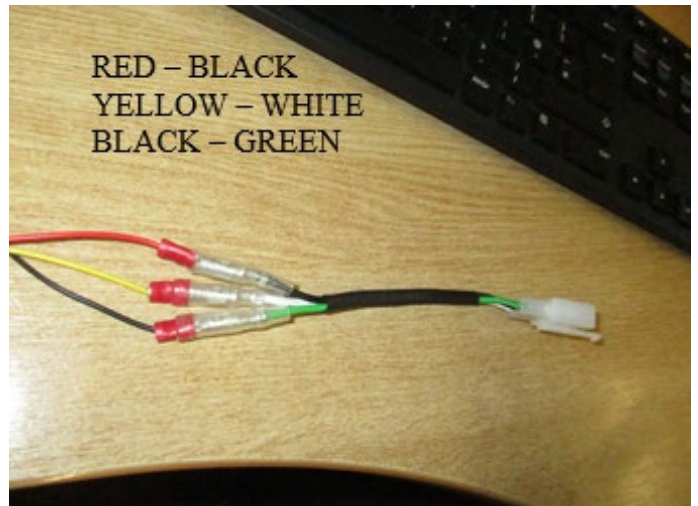

Picture 4



## **FITTING INSTRUCTIONS**

### **Removal of OEM license plate bracket**

- Begin by removing the seat mount bolts as shown in **Picture 1**.
- Un-plug the OEM tail-light connector as shown in **Picture 2**.
- Remove the 4 x bolts which secure the OEM license plate holder to the bike which are located under the seat.

### **Assembly of R&G Tail Tidy**

- Present the R&G tail tidy to the underside of the bike and secure using the 4 x OEM mounting bolts from the underside of the bike as shown in the **Assembly Diagram** along with the 8 x washers (**item 9**) and 4 x nyloc nuts (**item 10**).
- Secure the provided bullet connectors (**item 12**) to the 3 x wires which come out of the R&G Tail light assembly as shown in **Picture 3**.
- Attach the R&G Tail light assembly (**items 2 and 3**) as shown in the **Assembly Diagram** above.
- Connect the bullet connectors from the R&G Tail light to the provided connector as shown in **Picture 4**.
- Now, plug in this connector to your existing wiring loom to ensure your brake light and license plate illuminator function properly.
- To protect the cables, use 1 x length of the provided heat-shrink (**item 11**) and also as shown in the **Assembly Diagram** above, please insert the rubber grommet to ensure the cable is safe.
- Use the provided cable clips (**item 7**) to tidy the cable attaching it to the of the R&G tail tidy (**item 1**).

*Ensure that the wiring does not foul or become trapped during operation.*

**IMPORTANT: IF FITTING A FULL-SIZE LICENCE PLATE AND PLACING IT FAR DOWN ON THE LICENCE PLATE HANGER, THERE IS A SMALL CHANCE OF THE LICENCE PLATE HITTING THE BACK WHEEL UNDER HEAVY LOAD AND OVER LARGE BUMPS IN THE**

R&G

Unit 1, Shelley's Lane, East Worldham, Alton, Hampshire, GU34 3AQ

Tel: +44 (0)1420 89007 Fax: +44 (0)1420 87301 [www.rg-racing.com](http://www.rg-racing.com) Email: [info@rg-racing.com](mailto:info@rg-racing.com)



**ROAD. IT IS YOUR RESPONSIBILITY TO CHECK FOR THIS POSSIBILITY AND TAKE AVOIDING ACTION. FAILURE TO CHECK THIS COULD RESULT IN SERIOUS INJURY.**

ISSUE 2 - 01/06/2022 - (AO)

#### **CONSUMER NOTICE**

The catalogue description and any exhibition of samples are only broad indications of the Products and R&G may make design changes which do not diminish their performance or visual appeal and supplying them in such state shall conform to the order. The Buyer acknowledges no representation or warranty (other than as to title) has been given or will apply to the Products other than those in R&G's order or confirmation and the Buyer confirms it has chosen the Products as being of merchantable quality and suitable for its particular purposes. Where R&G fits the Products or undertakes other services it shall exercise reasonable skill and care and rectify any fault free of charge unless the workmanship has been disturbed. The Buyer is responsible for ensuring that the warranty on the motorcycle is not affected by the fitting of the Products. On return of any defective Products R&G shall at its option either supply a replacement or refund the purchase money but shall not be liable if the Products have been modified or used or maintained otherwise than in accordance with R&G's or manufacturer's instructions and good engineering practice or if the defect arises from accident or neglect. Other than identified above and subject to R&G not limiting its liability for causing death and personal injury, it shall not be liable for indirect or consequential loss and otherwise its liability shall be limited to the amounts paid by the Buyer for the Products or the fitting or service concerned. These terms do not affect the Buyer's statutory rights.

#### **R&G RACING RETURNS POLICY (NON-FAULTY GOODS)**

Returns must be pre-authorized (if not pre-authorized the return will be rejected). Goods may only be returned direct to us if they were purchased direct from us (customer must prove if necessary). Otherwise to be returned to original vendor. Goods must be in re-sellable condition, in the opinion of R&G Racing. All returns are subject to a 25% restocking and handling fee (25% of the gross value exc. P&P – at the prevailing price at time of purchase). The customer must pay any and all carriage charges. No returns of discontinued products, unless within 14 days of purchase. This policy does not affect your statutory rights and does not refer to faulty goods.

R&G

Unit 1, Shelley's Lane, East Worldham, Alton, Hampshire, GU34 3AQ

Tel: +44 (0)1420 89007 Fax: +44 (0)1420 87301 [www.rg-racing.com](http://www.rg-racing.com) Email: [info@rg-racing.com](mailto:info@rg-racing.com)



**NOTICE DE MONTAGE POUR LP0332 SUPPORT DE PLAQUE**  
**KAWASAKI KLR650 2022-**



**Ce kit contient les éléments illustrés et étiquetés sur la page.  
Certaines pièces peuvent être montrées uniquement pour la clarté des  
instructions.**

**Vérifiez que toutes les pièces soient présentes.**

**Veillez lire toutes les instructions avant de continuer.**

**EN CAS DE DOUTE LORS DE L'INSTALLATION, CONSULTEZ L'UN DE NOS  
REVENDEURS OU FAITES INSTALLER PAR UN TECHNICIEN QUALIFIÉ.**

Veillez noter que la façon dont le kit est emballé ne représente pas nécessairement le mode de montage sur la moto.

En cas d'utilisation de rondelles en caoutchouc pour maintenir les composants sur les boulons, ces rondelles en caoutchouc peuvent être jetées.

**DIGITAL COPIES OF THESE INSTRUCTIONS ARE AVAILABLE FROM**

**[WWW.RG-RACING.COM](http://WWW.RG-RACING.COM)**

R&G

Unit 1, Shelley's Lane, East Worldham, Alton, Hampshire, GU34 3AQ

Tel: +44 (0)1420 89007 Fax: +44 (0)1420 87301 [www.rg-racing.com](http://www.rg-racing.com) Email: [info@rg-racing.com](mailto:info@rg-racing.com)



<b><u>OUTILS REQUIS</u></b>	<b><u>VALEURS DE SERRAGE</u></b>
<ul style="list-style-type: none"> <li>• Clés Allen.</li> <li>• Clé à cliquet + douilles 8, 10 ,12 et 13mm.</li> <li>• Pince à bec large.</li> <li>• Petit tournevis plat.</li> </ul>	M4 BOULON = 8Nm M5 BOULON = 12Nm M6 BOULON = 15Nm M8 BOULON = 20Nm M10 BOULON = 40Nm M12 BOULON = 40Nm

### **LÉGENDE**

<b>ARTICLE No.</b>	<b>DESCRIPTION</b>	<b>QTÉ</b>
ARTICLE 1	TB0332 (SUPPORT DE PLAQUE)	1
ARTICLE 2	LA0006 (ENSEMBLE FEU ARRIÈRE CABOCHON FUMÉ)	1
ARTICLE 3	LA0003 (PROTECTION ÉCLAIRAGE)	1
ARTICLE 4	CON0068 (CONNECTEUR FEU DE PLAQUE)	1
ARTICLE 5	REFL3 (REFLECTEUR)	1
ARTICLE 6	RB0008 (OEILLET EN CAOUTCHOUC)	1
ARTICLE 7	CLIP1 (CLIP AUTOCOLLANT)	5
ARTICLE 8	M6 x 25mm BOULON	4
ARTICLE 9	M6 x 12mm RONDELLE	8
ARTICLE 10	M6 ÉCROU	4
ARTICLE 11	666-896/23 (230mm LONGUEUR DE MANCHON THERMO RÉTRACTABLE)	1
ARTICLE 12	CON0004 (3.5mm CONNECTEURS BULLET)	2

R&amp;G

Unit 1, Shelley's Lane, East Worldham, Alton, Hampshire, GU34 3AQ

Tel: +44 (0)1420 89007 Fax: +44 (0)1420 87301 [www.rg-racing.com](http://www.rg-racing.com) Email: [info@rg-racing.com](mailto:info@rg-racing.com)





**SCHÉMA D'ENSEMBLE**

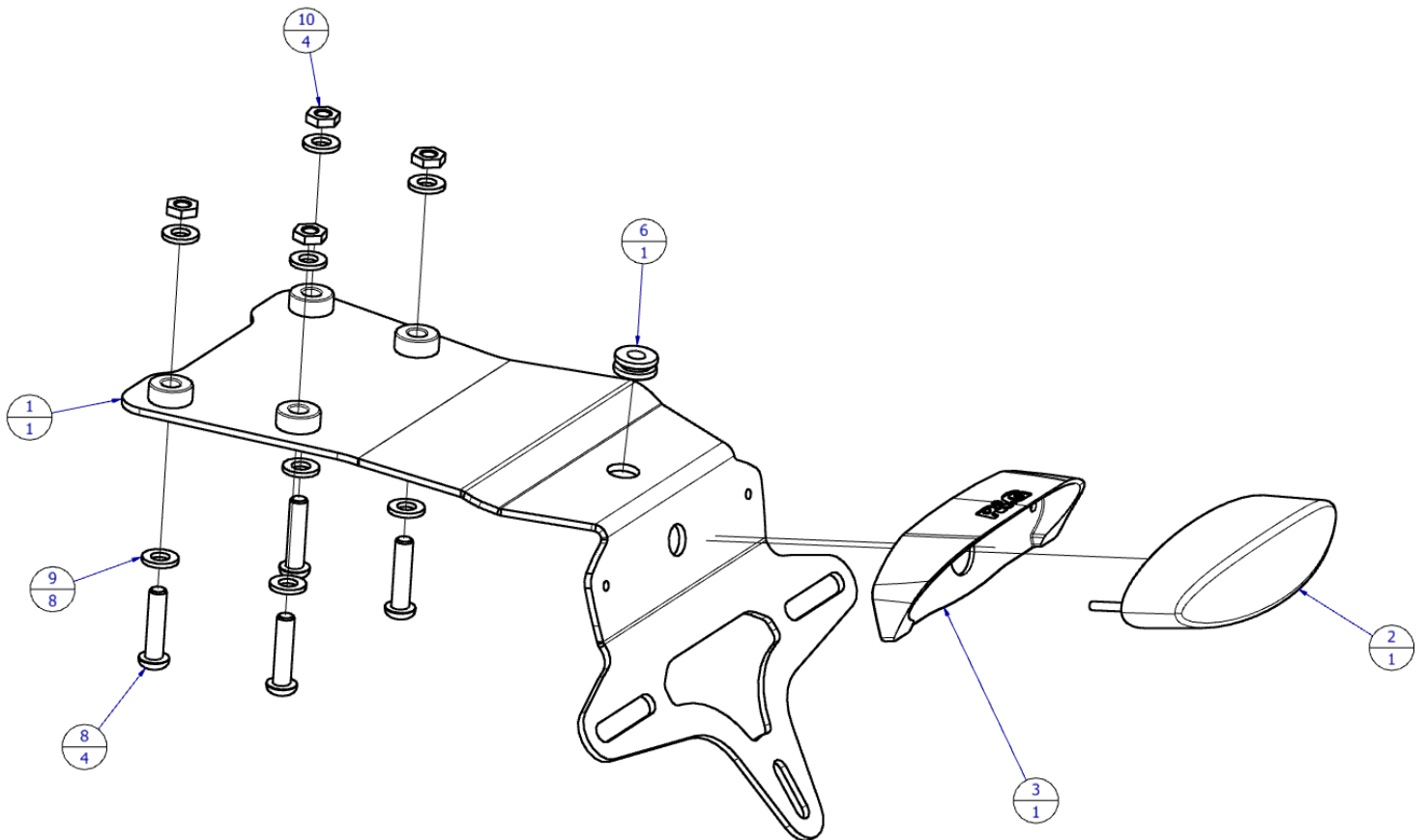

R&G

Unit 1, Shelley's Lane, East Worldham, Alton, Hampshire, GU34 3AQ

Tel: +44 (0)1420 89007 Fax: +44 (0)1420 87301 [www.rg-racing.com](http://www.rg-racing.com) Email: [info@rg-racing.com](mailto:info@rg-racing.com)



**PHOTOS DE MONTAGE**



Photo 1

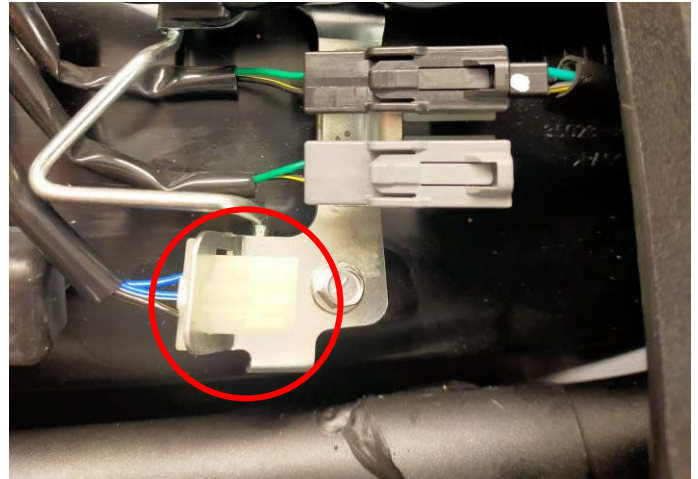

Photo 2

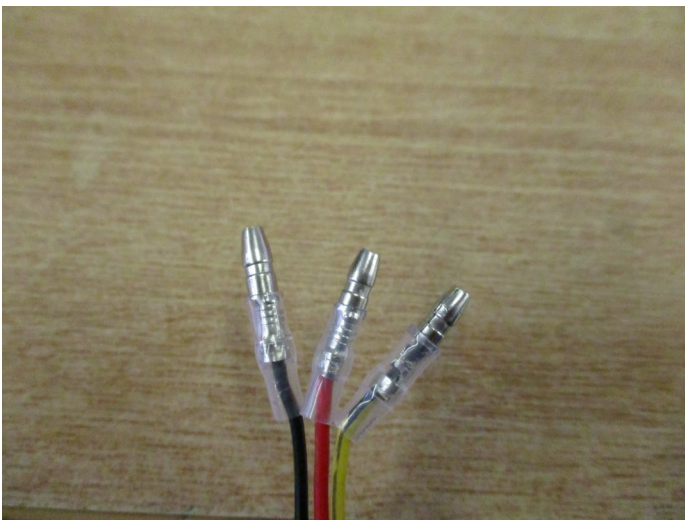

Photo 3

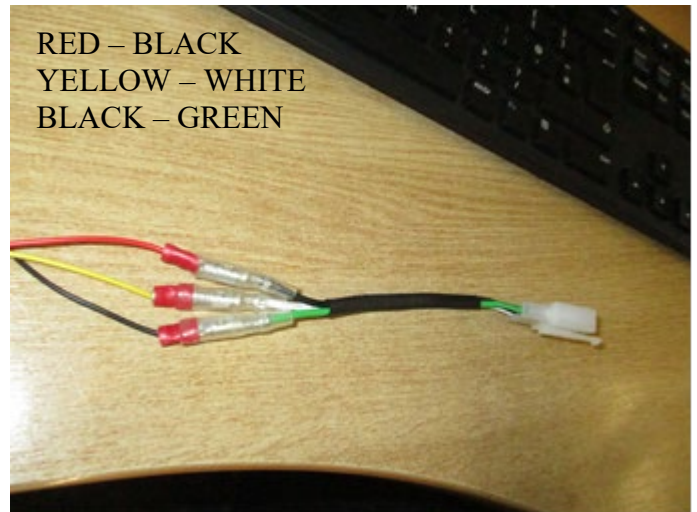

Photo 4



## **NOTICE DE MONTAGE**

### **Enlever le support de plaque d'origine**

- Commencez par retirer les boulons de fixation du siège comme indiqué sur la photo 1.
- Débranchez le connecteur du feu arrière d'origine comme indiqué sur la photo 2.
- Retirez les 4 x boulons qui fixent le support de plaque d'immatriculation d'origine à la moto et qui se trouvent sous la selle.

### **Assembler le support R&G**

- Présentez le support arrière R&G sur le dessous de la moto et fixez-le à l'aide des 4 boulons de montage d'origine du dessous de la moto, comme indiqué dans le schéma de montage, ainsi que des 8 rondelles (article 9) et des 4 écrous nyloc (article 10).
- Fixez l'ensemble de feu arrière R&G (articles 2 et 3) comme indiqué sur le schéma de montage ci-dessus.
- Connectez les connecteurs du feu arrière R&G au connecteur fourni comme indiqué sur la photo 4.
- Maintenant, branchez ce connecteur à votre faisceau de câbles existant pour vous assurer que votre feu stop et votre éclairage de plaque d'immatriculation fonctionnent correctement.
- Pour protéger les câbles, utilisez x1 longueur de la gaine thermo rétractable fournie (article 11) et également comme indiqué dans le schéma de montage ci-dessus, veuillez insérer le passe-fil en caoutchouc pour garantir la sécurité du câble.
- Utilisez les serre-câbles fournis (article 7) pour ranger le câble en le fixant sur le range-câbles R&G (article 1).

*Assurez-vous que le câblage ne s'encrasse pas ou ne se coince pas pendant le fonctionnement.*

**IMPORTANT : SI VOUS MONTEZ UNE PLAQUE D'IMMATRICULATION DE GRANDE TAILLE ET QUE VOUS LA PLACEZ TROP BAS SUR LE SUPPORT DE PLAQUE D'IMMATRICULATION, IL Y A UN RISQUE QUE LA PLAQUE D'IMMATRICULATION TOUCHE LA ROUE ARRIÈRE SI VOUS ROULEZ SUR UNE BOSSE. IL EST DE VOTRE RESPONSABILITÉ DE VÉRIFIER CETTE POSSIBILITÉ ET DE PRENDRE DES MESURES POUR ÉVITER. NE PAS VÉRIFIER CELA POURRAIT ENTRAÎNER DES BLESSURES GRAVES.**

ISSUE 2 - 01/06/2022 - (AO)

### **CONSUMER NOTICE**

R&G

Unit 1, Shelley's Lane, East Worldham, Alton, Hampshire, GU34 3AQ

Tel: +44 (0)1420 89007 Fax: +44 (0)1420 87301 [www.rg-racing.com](http://www.rg-racing.com) Email: [info@rg-racing.com](mailto:info@rg-racing.com)



The catalogue description and any exhibition of samples are only broad indications of the Products and R&G may make design changes which do not diminish their performance or visual appeal and supplying them in such state shall conform to the order. The Buyer acknowledges no representation or warranty (other than as to title) has been given or will apply to the Products other than those in R&G's order or confirmation and the Buyer confirms it has chosen the Products as being of merchantable quality and suitable for its particular purposes. Where R&G fits the Products or undertakes other services it shall exercise reasonable skill and care and rectify any fault free of charge unless the workmanship has been disturbed. The Buyer is responsible for ensuring that the warranty on the motorcycle is not affected by the fitting of the Products. On return of any defective Products R&G shall at its option either supply a replacement or refund the purchase money but shall not be liable if the Products have been modified or used or maintained otherwise than in accordance with R&G's or manufacturer's instructions and good engineering practice or if the defect arises from accident or neglect. Other than identified above and subject to R&G not limiting its liability for causing death and personal injury, it shall not be liable for indirect or consequential loss and otherwise its liability shall be limited to the amounts paid by the Buyer for the Products or the fitting or service concerned. These terms do not affect the Buyer's statutory rights.

#### **R&G RACING RETURNS POLICY (NON-FAULTY GOODS)**

Returns must be pre-authorized (if not pre-authorized the return will be rejected). Goods may only be returned direct to us if they were purchased direct from us (customer must prove if necessary). Otherwise to be returned to original vendor. Goods must be in re-sellable condition, in the opinion of R&G Racing. All returns are subject to a 25% restocking and handling fee (25% of the gross value exc. P&P - at the prevailing price at time of purchase). The customer must pay any and all carriage charges. No returns of discontinued products, unless within 14 days of purchase. This policy does not affect your statutory rights and does not refer to faulty goods.

R&G

Unit 1, Shelley's Lane, East Worldham, Alton, Hampshire, GU34 3AQ

Tel: +44 (0)1420 89007 Fax: +44 (0)1420 87301 [www.rg-racing.com](http://www.rg-racing.com) Email: [info@rg-racing.com](mailto:info@rg-racing.com)



**MONTAGEANLEITUNG FÜR LP0332 KENNZEICHENHALTER**  
**KAWASAKI KLR650 2022-**



**Alle Kit-Teile sind auf den nachfolgenden Seiten abgebildet und gekennzeichnet.**

**Die abgebildeten Teile dienen lediglich zur Erklärung.**

**Überprüfen Sie zuerst, dass alle Teile vorhanden sind.**

**Lesen Sie die Montageanleitung komplett durch, bevor Sie anfangen.**

**WENN SIE BEI DER MONTAGE DIESES PRODUKTES UNSICHER SIND, BITTE EINEN**  
**UNSERER HÄNDLER KONTAKTIEREN ODER DAS KIT VON EINEM QUALIFIZIERTEN**  
**ZWEIRAD-MECHANIKER MONTIEREN LASSEN.**

Die Verpackung der Teile stellt nicht die Reihenfolge der Montage dar.

Hinweis für Kits mit Plastikunterlegscheiben an den Schrauben –  
Diese Plastik-Unterlegscheiben werden nicht für den Einbau benötigt

**EINE DIGITALE VERSION DIESER MONTAGEANLEITUNG KANN AUF**  
**FOLGENDER SEITE HERUNTERGELADEN WERDEN:**  
**[WWW.RG-RACING.COM](http://WWW.RG-RACING.COM)**

R&G

Unit 1, Shelley's Lane, East Worldham, Alton, Hampshire, GU34 3AQ  
Tel: +44 (0)1420 89007 Fax: +44 (0)1420 87301 [www.rg-racing.com](http://www.rg-racing.com) Email: [info@rg-racing.com](mailto:info@rg-racing.com)



<b><u>SIE BENÖTIGEN FOLGENDES WERKZEUG</u></b>	<b><u>ALLGEM. ANZUGSDREHMOMENT</u></b>
<ul style="list-style-type: none"> <li>• Satz Inbusschlüssel</li> <li>• Steckschlüsselsatz inkl. 8, 10 ,12 und 13mm A/F</li> <li>• Spitzzange</li> <li>• Kreuzschlitzschraubenzieher</li> <li>• Flachklingschraubenzieher</li> </ul>	<p>M4 SCHRAUBE = 8Nm            M5 SCHRAUBE = 12Nm            M6 SCHRAUBE = 15Nm            M8 SCHRAUBE = 20Nm            M10 SCHRAUBE = 40Nm            M12 SCHRAUBE = 40Nm</p>

### **LIEFERUMFANG**

<b>ARTIKEL NR.</b>	<b>BESCHREIBUNG</b>	<b>MENGE</b>
ARTIKEL 1	TB0332 (KENNZEICHENHALTER)	1
ARTIKEL 2	LA0006 (KENNZEICHENBELEUCHTUNG - LEICHT GETÖNTE SCHEIBE)	1
ARTIKEL 3	LA0003 (RÜCKLICHT-ABDECKUNG)	1
ARTIKEL 4	CON0068 (RÜCKLICHT - VERBINDER)	1
ARTIKEL 5	RÜCKSTRAHLER (REFLECTOR)	1
ARTIKEL 6	RB0008 (GUMMITÜLLE)	1
ARTIKEL 7	CLIP1 (SELBSTKLEBENDER CLIP)	5
ARTIKEL 8	M6 x 25mm INBUSSCHRAUBE	4
ARTIKEL 9	M6 x 12mm OD UNTERLEGSCHEIBE	8
ARTIKEL 10	M6 SELBSTSICHERNDE MUTTER	4
ARTIKEL 11	666-896/23 (230mm SCHRUMPFSCHLAUCH)	1
ARTIKEL 12	CON0004 (3.5mm RUNDSTECKVERBI NDER)	2

R&G

Unit 1, Shelley's Lane, East Worldham, Alton, Hampshire, GU34 3AQ

Tel: +44 (0)1420 89007 Fax: +44 (0)1420 87301 [www.rg-racing.com](http://www.rg-racing.com) Email: [info@rg-racing.com](mailto:info@rg-racing.com)



**ZUSAMMENBAU - ZEICHNUNG**

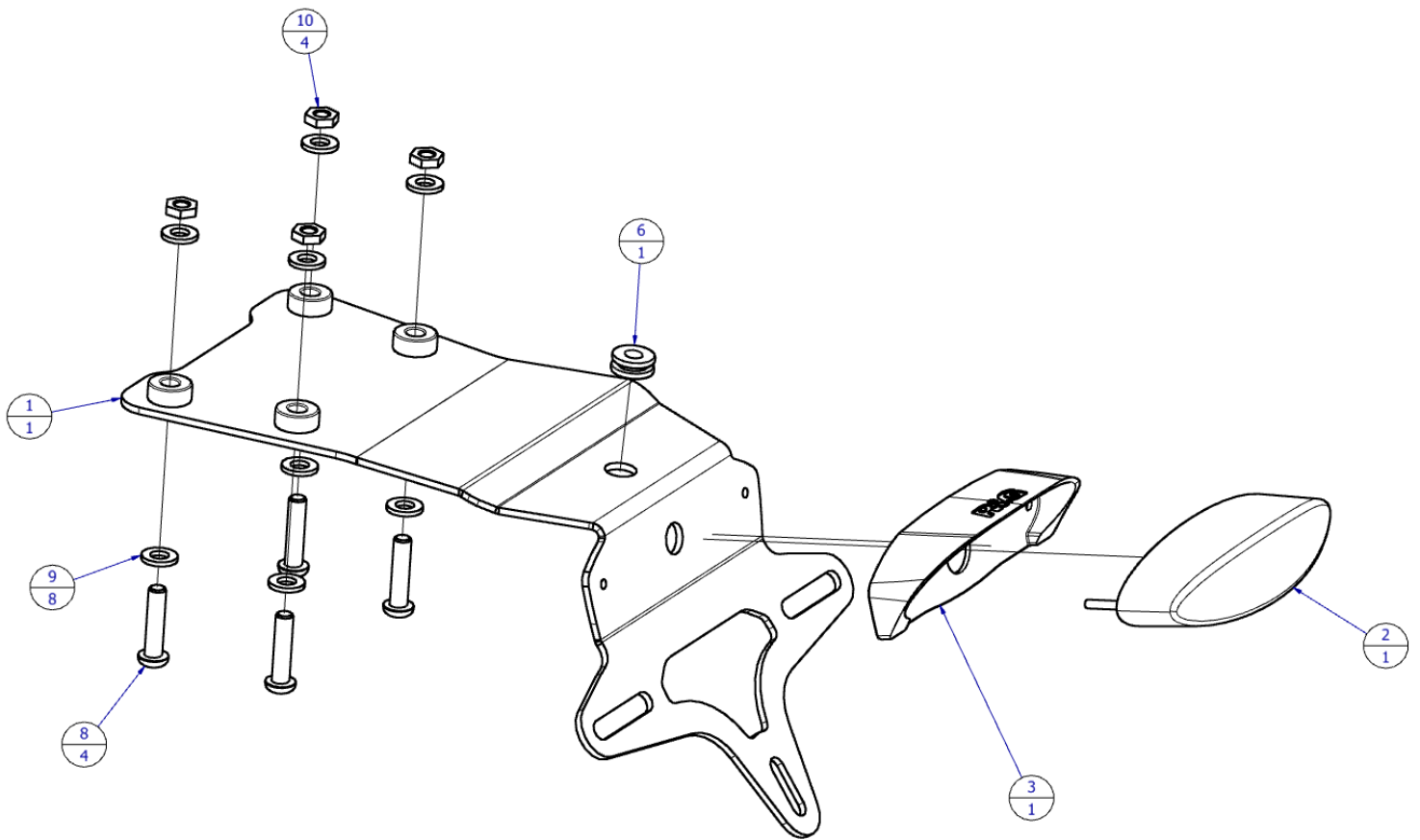

R&G

Unit 1, Shelley's Lane, East Worldham, Alton, Hampshire, GU34 3AQ

Tel: +44 (0)1420 89007 Fax: +44 (0)1420 87301 [www.rg-racing.com](http://www.rg-racing.com) Email: [info@rg-racing.com](mailto:info@rg-racing.com)



## MONTAGE - ABBILDUNGEN



Abbildung 1



Abbildung 2



Abbildung 3

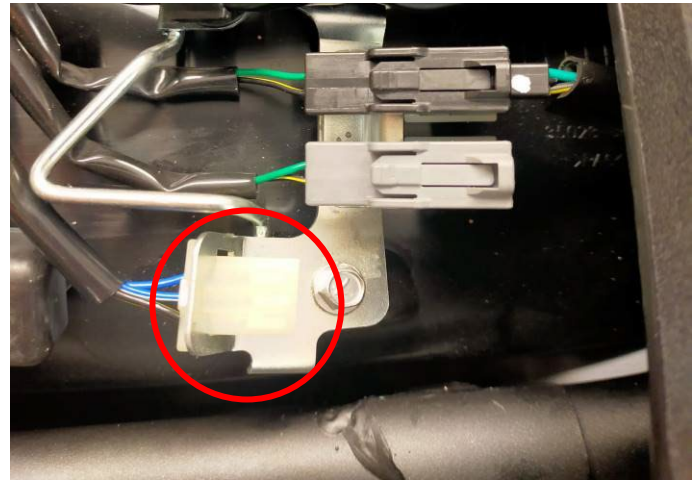

Abbildung 4

## MONTAGEANLEITUNG

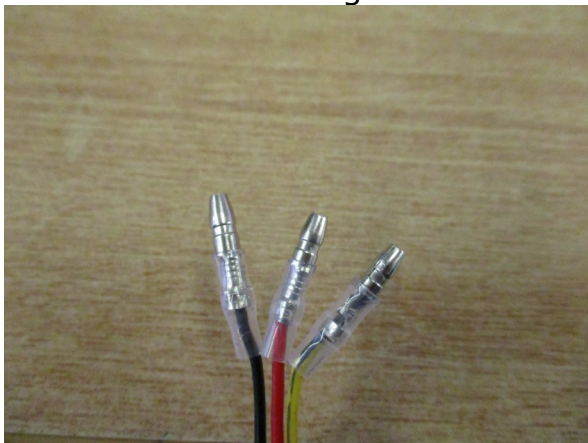
### **Entfernung des original Kennzeichenhalters**

- Entfernen Sie zuerst die Schrauben für die Sitzhalterung wie in **Abbildung 1** abgebildet.
- Die original Steckverbindung für die Kennzeichenbeleuchtung ausstöpseln wie in **Abbildung 2** abgebildet.
- Entfernen Sie die 4 Schrauben unter dem Sitz, die den original Kennzeichenhalter am Motorrad befestigen.

### **Montage des R&G Kennzeichenhalters**

- Den R&G Kennzeichenhalter an der Unterseite des Motorrads ansetzen und mit den 4 Originalschrauben, 8 Unterlegscheiben (**Artikel 9**) und 4 selbstsichernden Muttern (**Artikel 10**) von der Unterseite des Motorrads beginnend befestigen (siehe **Zeichnung Zusammenbau**).

R&G

Unit 1, Shelley's Lane, East Worldham, Alton, Hampshire, GU34 3AQ

Tel: +44 (0)1420 89007 Fax: +44 (0)1420 87301 [www.rg-racing.com](http://www.rg-racing.com) Email: [info@rg-racing.com](mailto:info@rg-racing.com)





- Die R&G Kennzeichenbeleuchtung (**Artikel 2 und 3**) anbringen wie in der **Zeichnung Zusammenbau** oben abgebildet.
- Verbinden Sie die Kabelverbinder der R&G Kennzeichenbeleuchtung mit dem mitgelieferten Verbinder wie in **Abbildung 4** abgebildet.
- Den Verbinder nun mit dem vorhandenen Kabelbaum verbinden und sicherstellen, dass die Beleuchtung des Kennzeichenhalters und Bremslichts ordnungsgemäß funktioniert.
- Benutzen Sie eine Länge Schrumpfschlauch (**Artikel 11**), um die Kabel zu schützen und, wie in der **Zeichnung Zusammenbau** oben abgebildet, die Gummitülle einsetzen, um das Kabel zu sichern.
- Benutzen Sie die Kabelclips vom Kit (**Artikel 7**), um das mit dem Kennzeichenhalter (**Artikel 1**) verbundene Kabel ordentlich zu verstauen/sichern.

Stellen Sie sicher, dass die Verkabelung nicht während der Fahrt eingeklemmt oder locker werden kann.

**WICHTIG: WENN EIN GROSSES KENNZEICHEN ZU WEIT NACH UNTEN MONTIERT WIRD, BESTEHT BEI SCHWERER LAST ODER DURCH GROSSE BODENWELLEN EIN GERINGES RISIKO, DASS DAS KENNZEICHEN AN DAS HINTERRAD STOSSEN KANN. ES LIEGT IN IHRER VERANTWORTUNG DIES ZU ÜBERPRÜFEN UND, WENN NOTWENDIG, VORBEUGENDE MASSNAHMEN ZU ERGREIFEN. DIE NICHTBEACHTUNG DIESER SICHERHEITSHINWEISES KANN ZU SCHWEREN VERLETZUNGEN FÜHREN.**

AUSGABE 2 - 01/06/2022 - (AO)

#### CONSUMER NOTICE

The catalogue description and any exhibition of samples are only broad indications of the Products and R&G may make design changes which do not diminish their performance or visual appeal and supplying them in such state shall conform to the order. The Buyer acknowledges no representation or warranty (other than as to title) has been given or will apply to the Products other than those in R&G's order or confirmation and the Buyer confirms it has chosen the Products as being of merchantable quality and suitable for its particular purposes. Where R&G fits the Products or undertakes other services it shall exercise reasonable skill and care and rectify any fault free of charge unless the workmanship has been disturbed. The Buyer is responsible for ensuring that the warranty on the motorcycle is not affected by the fitting of the Products. On return of any defective Products R&G shall at its option either supply a replacement or refund the purchase money but shall not be liable if the Products have been modified or used or maintained otherwise than in accordance with R&G's or manufacturer's instructions and good engineering practice or if the defect arises from accident or neglect. Other than identified above and subject to R&G not limiting its liability for causing death and personal injury, it shall not be liable for indirect or consequential loss and otherwise its liability shall be limited to the amounts paid by the Buyer for the Products or the fitting or service concerned. These terms do not affect the Buyer's statutory rights.

#### R&G RACING RETURNS POLICY (NON-FAULTY GOODS)

Returns must be pre-authorized (if not pre-authorized the return will be rejected). Goods may only be returned direct to us if they were purchased direct from us (customer must prove if necessary). Otherwise to be returned to original vendor. Goods must be in re-sellable condition, in the opinion of R&G Racing. All returns are subject to a 25% restocking and handling fee (25% of the gross value exc. P&P – at the prevailing price at time of purchase). The customer must pay any and all carriage charges. No returns of discontinued products, unless within 14 days of purchase. This policy does not affect your statutory rights and does not refer to faulty goods.

R&G

Unit 1, Shelley's Lane, East Worldham, Alton, Hampshire, GU34 3AQ

Tel: +44 (0)1420 89007 Fax: +44 (0)1420 87301 [www.rg-racing.com](http://www.rg-racing.com) Email: [info@rg-racing.com](mailto:info@rg-racing.com)