

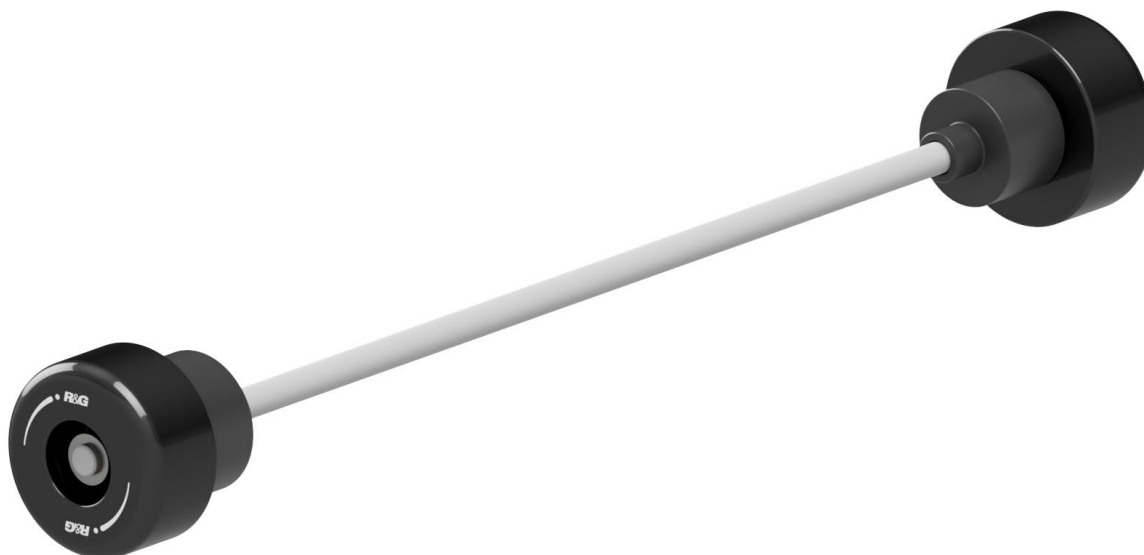

**FITTING INSTRUCTIONS FOR SP0112**  
**SWINGARM PROTECTORS**



**THIS KIT CONTAINS THE ITEMS PICTURED AND LABELLED OVER PAGE.**

SOME PARTS MAY BE SHOWN FOR CLARITY OF INSTRUCTIONS ONLY.

DO NOT PROCEED UNTIL YOU ARE SURE ALL PARTS ARE PRESENT.

**PLEASE READ ALL INSTRUCTIONS BEFORE PROCEEDING.**

**IF IN ANY DOUBT WHEN FITTING OUR PRODUCTS, CONSULT ONE OF OUR DEALERS  
OR HAVE FITTED BY A QUALIFIED TECHNICIAN.**

PLEASE NOTE THAT THE WAY THE KIT IS PACKED DOES NOT NECESSARILY REPRESENT THE WAY OF  
MOUNTING TO THE BIKE.

IN THE EVENT OF RUBBER WASHERS BEING USED TO HOLD COMPONENTS ONTO BOLTS,  
THESE RUBBER WASHERS CAN BE THROWN AWAY.

**DIGITAL COPIES OF THESE INSTRUCTIONS ARE AVAILABLE FROM:**

[WWW.RG-RACING.COM](http://WWW.RG-RACING.COM)

Racing Technique Ltd t/A R&G  
Unit 1, Shelleys Lane, East Worldham, Alton, Hampshire, GU 34 3AQ  
Tel: +44 (0)1420 89007 [www.rg-racing.com](http://www.rg-racing.com) Email: [infor@rg-racing.com](mailto:infor@rg-racing.com)



<u>TOOLS REQUIRED</u>	<u>GENERAL TORQUE SETTINGS</u>
<ul style="list-style-type: none"> <li>• 2x 13mm A/F SOCKETS &amp; WRENCHES</li> <li>• LOCTITE/SMALL AMOUNT OF SUPERGLUE</li> </ul>	<p>M4 BOLT = 8Nm</p> <p>M5 BOLT = 12Nm</p> <p>M6 BOLT = 15Nm</p> <p>M8 BOLT = 20Nm</p> <p>M10 BOLT = 40Nm</p> <p>M12 BOLT = 40Nm</p>

**LEGEND**

ITEM NO.	DESCRIPTION	QTY
ITEM 1	SB166 SPINDLE BAR (M8 - 370mm LENGTH)	1
ITEM 2	B0442 CRASH PROTECTOR	2
ITEM 3	S1590 LHS SPACER	1
ITEM 4	S1260 RHS SPACER	1
ITEM 5	M8 NUT	2
ITEM 6	M8 WASHER	2

**EXPLODED ASSEMBLY VIEW**

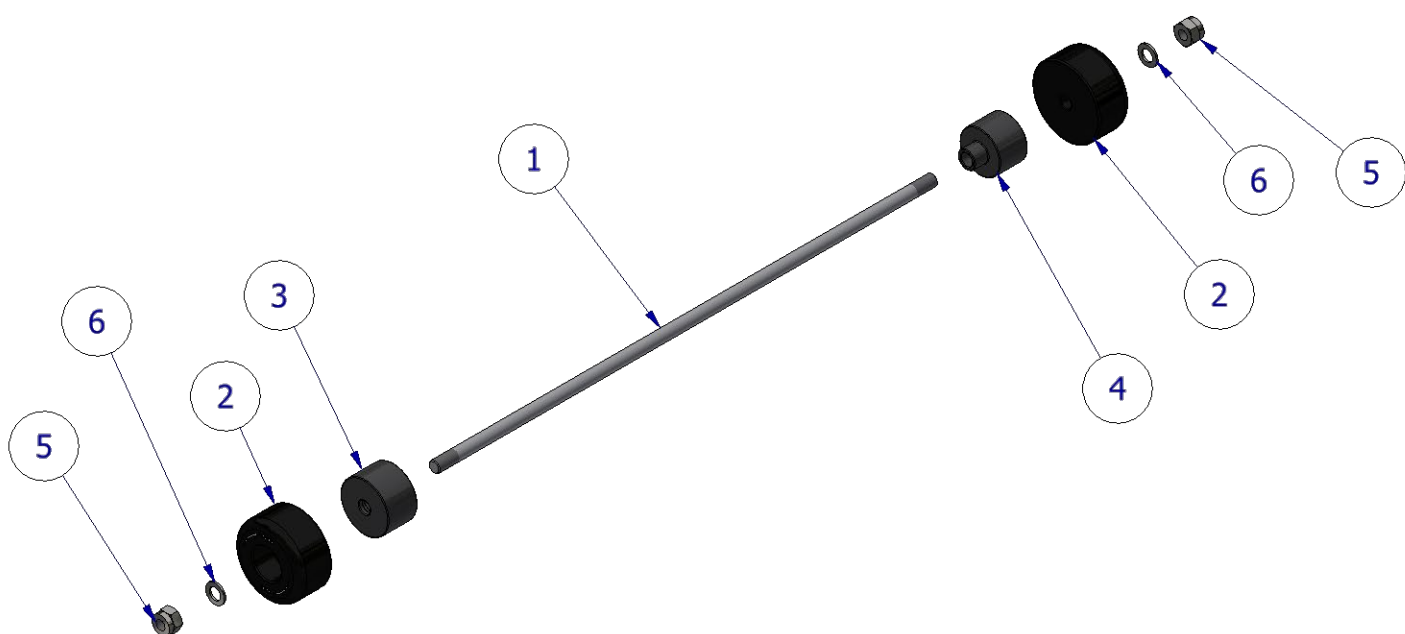



## **FITTING INSTRUCTIONS**

- Fit one nut (**item 5**) and washer (**item 6**) to either end of the included spindle bar (**item 1**), engaging the nut so the plastic insert of the nut is fully engaged, and the bar protrudes by 1 or 2 threads. It is recommended to use a small amount of superglue or Loctite to fix this nut as this will aid when tightening the opposite side later.
- Arrange the RHS assembly, as shown in the diagram on page 2, passing a crash protector (**item 2**) and the RHS spacer (**item 4**) over the assembled spindle bar, so the washer sits on the inner face of the crash protector. Slide this assembly through the hole in the swingarm spindle.
- Slide the LHS spacer (**item 3**) over the exposed end of the spindle bar, so that it covers the spindle nut, then follow with the remaining crash protector (**item 2**). Secure with the remaining washer (**item 6**) and nut (**item 5**).
- Finally tighten the nut on both sides evenly using two 13mm sockets and ensure that the plastic insert of both nuts are fully engaged, and the protruding threads are equal on both sides. Check the swingarm protectors are secure and held firmly against the spacers and do not spin.
- Do not overtighten – the Nyloc nuts will hold it tight.
- After riding the bike, check the tightness of the nuts regularly (e.g., when cleaning the bike).

ISSUE 1 - 22/01/2025 (MH)

### **CONSUMER NOTICE**

The catalogue description and any exhibition of samples are only broad indications of the Products and R&G may make design changes which do not diminish their performance or visual appeal and supplying them in such state shall conform to the order. The Buyer acknowledges no representation or warranty (other than as to title) has been given or will apply to the Products other than those in R&G's order or confirmation and the Buyer confirms it has chosen the Products as being of merchantable quality and suitable for its particular purposes. Where R&G fits the Products or undertakes other services it shall exercise reasonable skill and care and rectify any fault free of charge unless the workmanship has been disturbed. The Buyer is responsible for ensuring that the warranty on the motorcycle is not affected by the fitting of the Products. On return of any defective Products R&G shall at its option either supply a replacement or refund the purchase money but shall not be liable if the Products have been modified or used or maintained otherwise than in accordance with R&G's or manufacturer's instructions and good engineering practice or if the defect arises from accident or neglect. Other than identified above and subject to R&G not limiting its liability for causing death and personal injury, it shall not be liable for indirect or consequential loss and otherwise its liability shall be limited to the amounts paid by the Buyer for the Products or the fitting or service concerned. These terms do not affect the Buyer's statutory rights.

### **R&G RACING RETURNS POLICY (NON-FAULTY GOODS)**

Returns must be pre-authorized (if not pre-authorized the return will be rejected). Goods may only be returned direct to us if they were purchased direct from us (customer must prove if necessary). Otherwise to be returned to original vendor. Goods must be in re-sellable condition, in the opinion of R&G Racing. All returns are subject to a 25% restocking and handling fee (25% of the gross value exc. P&P – at the prevailing price at time of purchase). The customer must pay any and all carriage charges. No returns of discontinued products, unless within 14 days of purchase. This policy does not affect your statutory rights and does not refer to faulty goods.



**NOTICE DE MONTAGE POUR SP0112**  
**PROTECTIONS BRAS OSCILLANT**



**CE KIT CONTIENT LES ARTICLES ILLUSTRÉS ET ÉTIQUETES SUR LA PAGE.**

CERTAINES PARTIES PEUVENT ÊTRE PRÉSENTES UNIQUEMENT POUR LA CLARTÉ DES INSTRUCTIONS.

NE PAS PROCÉDER AU MONTAGE TANT QUE VOUS N'ÊTES PAS SÛR QUE TOUTES LES PIÈCES SOIENT PRÉSENTES.

**VEUILLEZ LIRE TOUTES LES INSTRUCTIONS AVANT DE CONTINUER.**

**EN CAS DE DOUTE LORS DU MONTAGE DE NOS PRODUITS, CONSULTEZ UN DE NOS REVENDEURS OU FAITES APPEL À UN TECHNICIEN QUALIFIÉ.**

VEUILLEZ NOTER QUE LA FAÇON DONT LE KIT EST EMBALLÉ NE REPRÉSENTE PAS NECESSAIREMENT LA MANIÈRE DE LE MONTER SUR LA MOTO.

SI DES RONDELLES EN CAOUTCHOUC SONT UTILISÉES POUR MAINTENIR LES COMPOSANTS SUR LES BOULONS, ELLES PEUVENT ÊTRE JETÉES.

**NOTICE DISPONIBLE AU TÉLÉCHARGEMENT SUR :**

[WWW.RG-RACING.COM](http://WWW.RG-RACING.COM)



<b><u>OUTILS REQUIS</u></b>	<b><u>VALEURS DE SERRAGE</u></b>
<ul style="list-style-type: none"> <li>• CLÉ À CLIQUET + DOUILLES 2x 13mm</li> <li>• LOCTITE / UN PEU DE SUPERGLUE</li> </ul>	M4 BOULON = 8Nm M5 BOULON = 12Nm M6 BOULON = 15Nm M8 BOULON = 20Nm M10 BOULON = 40Nm M12 BOULON = 40Nm

### **LÉGENDE**

<b>ARTICLE NO.</b>	<b>DESCRIPTION</b>	<b>QTÉ</b>
ARTICLE 1	SB166 BARRE (M8 - 370mm DE LONG)	1
ARTICLE 2	B0442 PROTECTION CRASH	2
ARTICLE 3	S1590 ENTRETOISE CÔTÉ GAUCHE	1
ARTICLE 4	S1260 ENTRETOISE CÔTÉ DROIT	1
ARTICLE 5	M8 ÉCROU	2
ARTICLE 6	M8 RONDELLE	2

### **VUE D'ENSEMBLE**

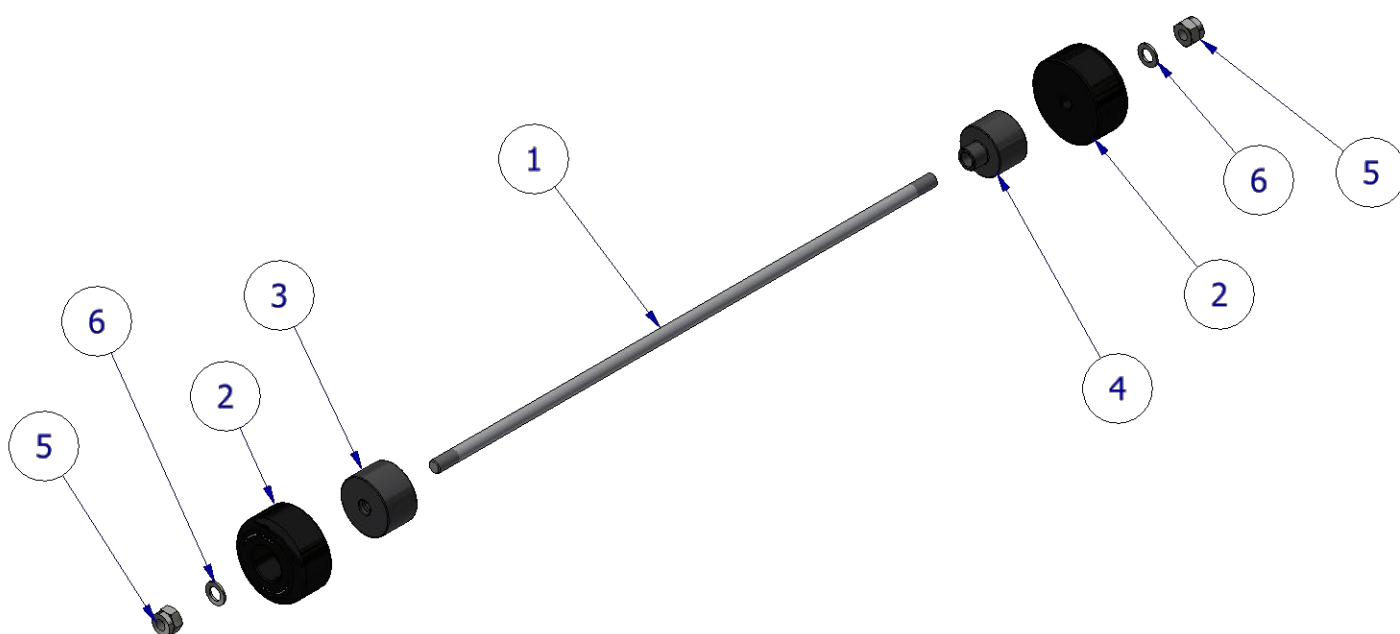



## **NOTICE DE MONTAGE**

- Montez un écrou (article 5) et une rondelle (article 6) à chaque extrémité de la barre incluse (article 1), en engageant l'écrou de manière à ce que l'insert en plastique de l'écrou soit complètement engagé et que la barre dépasse de 1 ou 2 filets. Il est recommandé d'utiliser une petite quantité de superglue ou de Loctite pour fixer cet écrou, car cela facilitera le serrage ultérieur du côté opposé.
- Disposez l'assemblage côté droit, comme indiqué sur le schéma de la page 2, en passant une protection crash (article 2) et l'entretoise côté droit (article 4) sur la barre assemblée, de sorte que la rondelle repose sur la face intérieure de la protection crash. Faites glisser cet ensemble dans le trou de l'axe du bras oscillant.
- Faites glisser l'entretoise côté gauche (article 3) sur l'extrémité exposée de la barre, de manière à ce qu'elle recouvre l'écrou de fusée, puis continuez avec la protection crash (article 2). Fixez avec la rondelle restante (article 6) et l'écrou (article 5).
- Enfin, serrez l'écrou des deux côtés de manière uniforme à l'aide de deux douilles de 13 mm et assurez-vous que l'insert en plastique des deux écrous soit complètement engagé et que les filetages saillants soient égaux des deux côtés. Vérifiez que les protections du bras oscillant soient bien fixées et maintenues fermement contre les entretoises et ne tournent pas.
- Ne serrez pas trop fort - les écrous Nyloc fixent l'ensemble.
- Après avoir roulé avec la moto, vérifiez régulièrement le serrage des écrous (par exemple, lors du nettoyage de la moto).

ISSUE 1 - 22/01/2025 (MH)

### **CONSUMER NOTICE**

The catalogue description and any exhibition of samples are only broad indications of the Products and R&G may make design changes which do not diminish their performance or visual appeal and supplying them in such state shall conform to the order. The Buyer acknowledges no representation or warranty (other than as to title) has been given or will apply to the Products other than those in R&G's order or confirmation and the Buyer confirms it has chosen the Products as being of merchantable quality and suitable for its particular purposes. Where R&G fits the Products or undertakes other services it shall exercise reasonable skill and care and rectify any fault free of charge unless the workmanship has been disturbed. The Buyer is responsible for ensuring that the warranty on the motorcycle is not affected by the fitting of the Products. On return of any defective Products R&G shall at its option either supply a replacement or refund the purchase money but shall not be liable if the Products have been modified or used or maintained otherwise than in accordance with R&G's or manufacturer's instructions and good engineering practice or if the defect arises from accident or neglect. Other than identified above and subject to R&G not limiting its liability for causing death and personal injury, it shall not be liable for indirect or consequential loss and otherwise its liability shall be limited to the amounts paid by the Buyer for the Products or the fitting or service concerned. These terms do not affect the Buyer's statutory rights.

### **R&G RACING RETURNS POLICY (NON-FAULTY GOODS)**

Returns must be pre-authorized (if not pre-authorized the return will be rejected). Goods may only be returned direct to us if they were purchased direct from us (customer must prove if necessary). Otherwise to be returned to original vendor. Goods must be in re-sellable condition, in the opinion of R&G Racing. All returns are subject to a 25% restocking and handling fee (25% of the gross value exc. P&P – at the prevailing price at time of purchase). The customer must pay any and all carriage charges. No returns of discontinued products, unless within 14 days of purchase. This policy does not affect your statutory rights and does not refer to faulty goods.