



FI0084

**FITTING INSTRUCTIONS FOR FI0084BK FRAME INSERT
DUCATI MONSTER 1200's 2014- RIGHT HAND SIDE REAR**

Page | 1



**THIS KIT CONTAINS THE ITEMS PICTURED AND LABELLED BELOW.
DO NOT PROCEED UNTIL YOU ARE SURE ALL PARTS ARE PRESENT.**

Please note that the way the kit is packed does not necessarily represent the way of mounting to the bike

THE PARTS SHOWN MAY BE REPRESENTATIVE ONLY (FOR CLARITY OF INSTRUCTIONS ONLY)

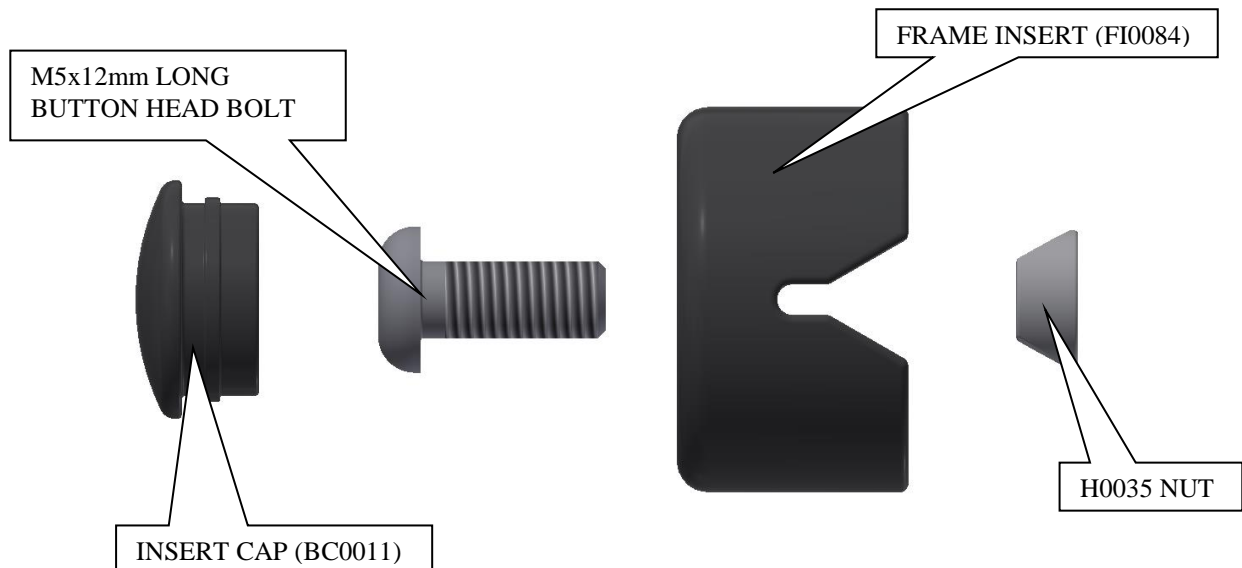

Please note that in cases where kits are packed with rubber washers holding the components onto the bolt – *the rubber washers should be thrown away!*

TOOLS REQUIRED

- SOFT MALLET.
- 3mm ALLEN KEY.

R&G Racing
Unit 1, Shelleys Lane, East Worldham, Alton, Hampshire, GU34 3AQ

Tel: +44 (0) 1420 89007 | Fax : +44 (0) 1420 87301 | Email: info@rg-racing.com



FI0084

Page | 2

Right-hand side (as you sit on bike)

- Take the plastic expanding frame insert and fit the M5 x 12mm long button head bolt into the recess, with the tapered nuts on the exposed end of the thread as shown above.
- Tighten the bolt with the frame insert off the bike until it just starts to compress and expand, and fit into the rear frame boss shown in the top picture, ensuring it is a fairly tight fit.
- A gentle tap with a soft mallet will help to locate the frame insert and once in place a further quarter turn on the bolt will hold the frame insert securely in place.
- Fit one of the plastic caps into the recess of the frame inserts so it sits flush with the top surface and conceals the bolt.
- *To remove the frame inserts, use a thin screwdriver or steel rule to pop the cap off and remove the M5 bolt. Then screw in a M6 bolt into the central hole and pull the insert out.*
- **Regularly check to ensure frame insert remains tight.**

ISSUE 1 NSY 16/03/2016

CONSUMER NOTICE

The catalogue description and any exhibition of samples are only broad indications of the Products and R&G may make design changes which do not diminish their performance or visual appeal and supplying them in such state shall conform to the order. The Buyer acknowledges no representation or warranty (other than as to title) has been given or will apply to the Products other than those in R&G's order or confirmation and the Buyer confirms it has chosen the Products as being of merchantable quality and suitable for its particular purposes. Where R&G fits the Products or undertakes other services it shall exercise reasonable skill and care and rectify any fault free of charge unless the workmanship has been disturbed. The Buyer is responsible for ensuring that the warranty on the motorcycle is not affected by the fitting of the Products. On return of any defective Products R&G shall at its option either supply a replacement or refund the purchase money but shall not be liable if the Products have been modified or used or maintained otherwise than in accordance with R&G's or manufacturer's instructions and good engineering practice or if the defect arises from accident or neglect. Other than identified above and subject to R&G not limiting its liability for causing death and personal injury, it shall not be liable for indirect or consequential loss and otherwise its liability shall be limited to the amounts paid by the Buyer for the Products or the fitting or service concerned. These terms do not affect the Buyer's statutory rights.

R&G RACING RETURNS POLICY (NON-FAULTY GOODS)

Returns must be pre-authorized (if not pre-authorized the return will be rejected). Goods may only be returned direct to us if they were purchased direct from us (customer must prove if necessary). Otherwise to be returned to original vendor. Goods must be in re-sellable condition, in the opinion of R&G Racing. All returns are subject to a 25% restocking and handling fee (25% of the gross value exc. P&P – at the prevailing price at time of purchase). The customer must pay any and all carriage charges. No returns of discontinued products, unless within 14 days of purchase. This policy does not affect your statutory rights and does not refer to faulty goods.

R&G Racing
Unit 1, Shelleys Lane, East Worldham, Alton, Hampshire, GU34 3AQ

Tel: +44 (0) 1420 89007 | Fax : +44 (0) 1420 87301 | Email: info@rg-racing.com



FI0084

**NOTICE DE MONTAGE FI0084BK INSERT DE CADRE
DUCATI MONSTER 1200's 2014- COTE ARRIERE DROIT**

Page | 3



Le kit contient les articles exposés ci-dessous, vérifier que toutes les pièces soient présentes avant de procéder au montage.

La façon dont le kit est emballé ne correspond pas forcément à la façon de monter les pièces sur la moto.

LES PARTIES PRESENTEES PEUVENT ETRE UNIQUEMENT REPRESENTATIVES (POUR LA CLARTE DES INSTRUCTIONS UNIQUEMENT)

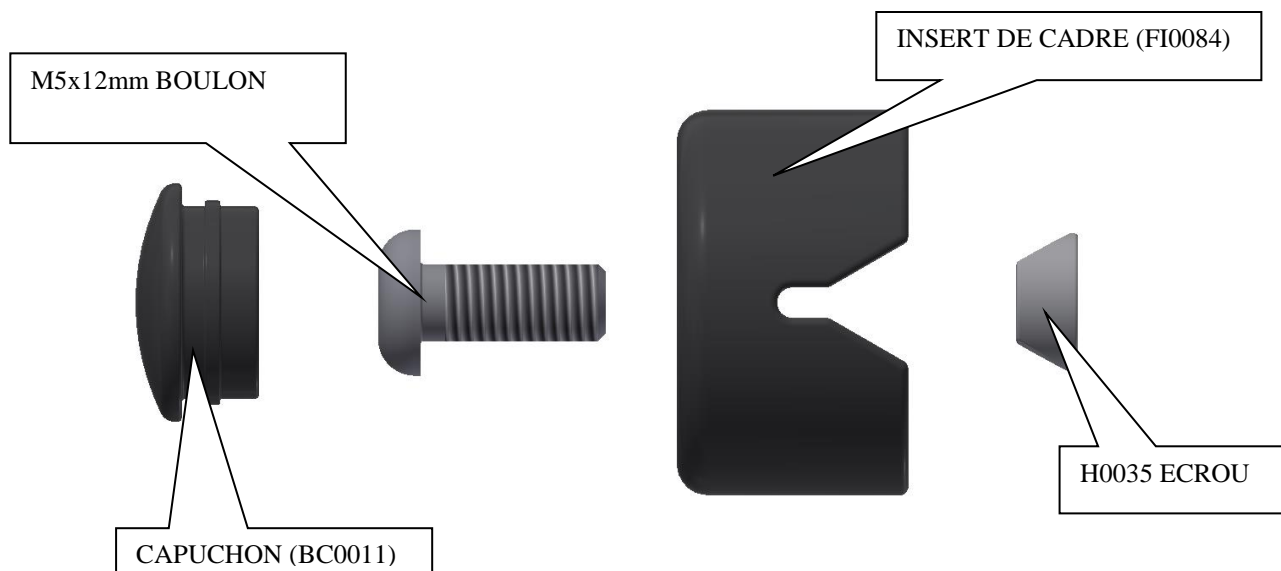

Notez que si les kits sont emballés avec des rondelles en caoutchouc servant à tenir les composants, *ces rondelles doivent être jetées!*



FI0084

OUTILS REQUIS

- MAILLET.
- CLE ALLEN 3mm.

Page | 4

Coté droit (assis sur la moto)

- Prendre l'insert de cadre et insérer un boulon M5 x 12mm dans le creux, avec des écrous crantés sur l'extrémité du filetage, voir ci-dessus.
- Serrer le boulon avec un insert de cadre jusqu'à ce qu'il commence à compresser et s'étendre, passez le dans le trou de cadre arrière indiqué sur la photo du haut, en veillant à ce qu'il soit correctement serré.
- Une petite tape à l'aide d'un maillet vous aidera à place l'insert de cadre et une fois en place, effectuez un quart de tour supplémentaire sur le boulon, ce qui fixera la position.
- Insérer des capuchons dans le creux des inserts de cadre de façon à cacher les boulons.
- *Pour enlever les inserts de cadre, utiliser un tournevis cruciforme ou une règle en fer pour enlever le capuchon et enlever le boulon M5. Ensuite, visser un boulon M6 dans le trou central et extraire l'insert.*
- **Vérifier le serrage régulièrement.**

ISSUE 1 NSY 16/03/2016

CONSUMER NOTICE

The catalogue description and any exhibition of samples are only broad indications of the Products and R&G may make design changes which do not diminish their performance or visual appeal and supplying them in such state shall conform to the order. The Buyer acknowledges no representation or warranty (other than as to title) has been given or will apply to the Products other than those in R&G's order or confirmation and the Buyer confirms it has chosen the Products as being of merchantable quality and suitable for its particular purposes. Where R&G fits the Products or undertakes other services it shall exercise reasonable skill and care and rectify any fault free of charge unless the workmanship has been disturbed. The Buyer is responsible for ensuring that the warranty on the motorcycle is not affected by the fitting of the Products. On return of any defective Products R&G shall at its option either supply a replacement or refund the purchase money but shall not be liable if the Products have been modified or used or maintained otherwise than in accordance with R&G's or manufacturer's instructions and good engineering practice or if the defect arises from accident or neglect. Other than identified above and subject to R&G not limiting its liability for causing death and personal injury, it shall not be liable for indirect or consequential loss and otherwise its liability shall be limited to the amounts paid by the Buyer for the Products or the fitting or service concerned. These terms do not affect the Buyer's statutory rights.

R&G RACING RETURNS POLICY (NON-FAULTY GOODS)

Returns must be pre-authorized (if not pre-authorized the return will be rejected). Goods may only be returned direct to us if they were purchased direct from us (customer must prove if necessary). Otherwise to be returned to original vendor. Goods must be in re-sellable condition, in the opinion of R&G Racing. All returns are subject to a 25% restocking and handling fee (25% of the gross value exc. P&P – at the prevailing price at time of purchase). The customer must pay any and all carriage charges. No returns of discontinued products, unless within 14 days of purchase. This policy does not affect your statutory rights and does not refer to faulty goods.

R&G Racing
Unit 1, Shelleys Lane, East Worldham, Alton, Hampshire, GU34 3AQ

Tel: +44 (0) 1420 89007 | Fax : +44 (0) 1420 87301 | Email: info@rg-racing.com